

Pushbuttons and Pilot Lights



PUSHBUTTONS



Controls

Pushbuttons and Pilot Lights - CSW Series

WEG has used its leading-edge technology & development capability to design the CSW series of pushbuttons, pilot lights, selector switches and accessories. These user friendly and durable Ø22mm pilot devices are used in many industrial applications and environments.

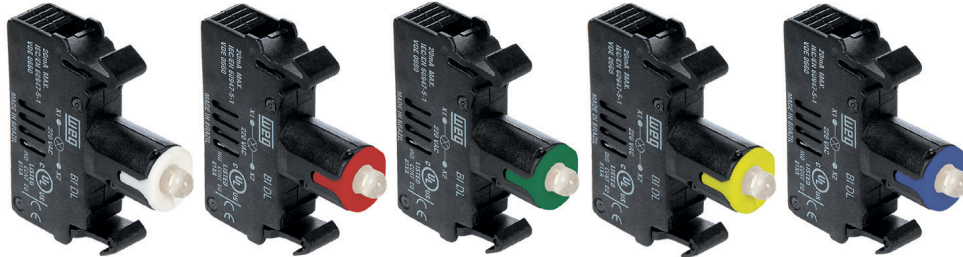

Besides the brightness, the BIDL blocks have many other valuable characteristics, such as:

- Long life expectancy
- Great performance on shock and vibration applications
- Extremely low power consumption and thermal dissipation
- High luminosity and color definition (independent of the lens)

Fast and easy assembling system

The Mounting of the contact blocks to the operator (pushbutton, selector switch or indicator) is done via a snap-on flange which ensures a fast tight fit. This system also can be removed quickly, without tools. Each single block can be mounted or removed individually: to assemble, just snap the components together and a common screwdriver is all that is necessary for disassembly. The ergonomic design of the new locking ring allows hand tightening, without the need for a screwdriver.

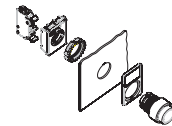

Contact blocks – safety and reliability

High efficiency self-cleaning contact blocks; Pure Silver Contacts (Ag100), ensures maximum reliability in every condition even at low energy levels (5mA/12V). NC Contacts with “Positive Break” system, ensures circuit interruption.

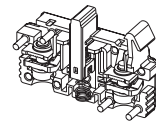

Accessories

A complete line of accessories is available including legend plates, protection covers, lenses for pilot lights, solid and engraved caps for flush pushbuttons.



Controls

Pushbuttons and Pilot Lights - CSW Series

N°	Description
1	Double Pushbutton
2	Protection Cover for Double Pushbutton
3	Illuminated Flush Pushbutton
4	Flush Pushbutton
5	Protection Cover for Flush Pushbutton
6	Selector Switch Knob
7	Selector Switch Lever
8	Illuminated Selector Switch
9	Key Switch
10	Pilot Light
11	Mushroom Pushbutton
12	Emergency-Stop Pushbutton - Twist Release
13	Emergency-Stop Pushbutton - Key Release
14	Plate Holder
15	Legend Plate
16	Double Contact Block
17	LED Block
18	Contact Block - NO or NC
19	Contact Block NCdb (delayed break)
20	Push-On / Push-Off Block
21	Contact Block NOem (early make)
22	Flange - 3 Positions
23	Flange - 5 Positions
24	Illuminated Extended Pushbutton
25	Illuminated Mushroom Pushbutton
26	Recessed Pushbutton
27	Protection Cover for BFI and BSI Pushbuttons
28	Plate Holder for Double Pushbutton
29	Emergency Pushbutton Protection
30	Emergency-Stop Pushbutton - Twist Release
31	Emergency-Stop Pushbutton - Pull Release
32	Emergency-Stop Pushbutton - Key Release

NEMA4X
IP66



Totally Insulated

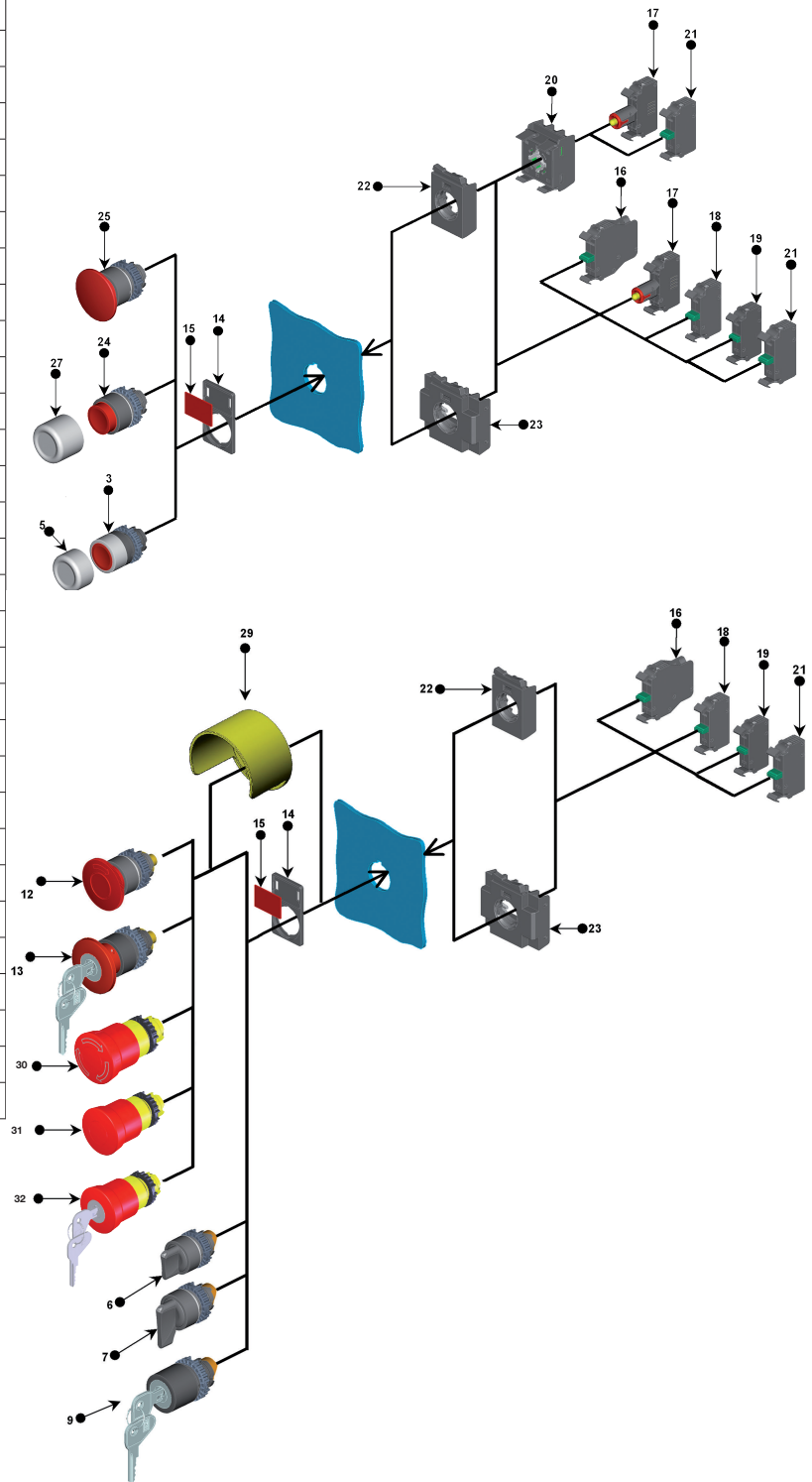

PUSHBUTTONS





Controls

Pushbuttons and Pilot Light - CSW Series

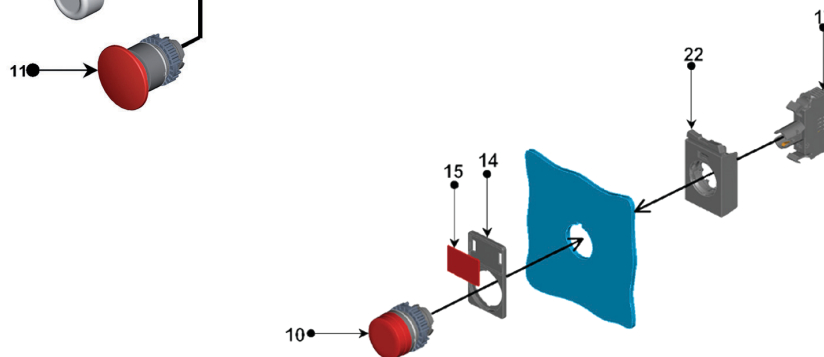
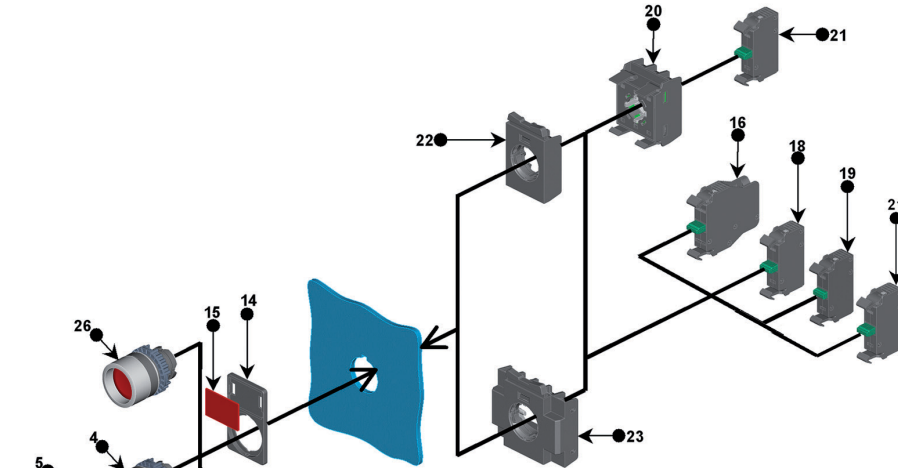
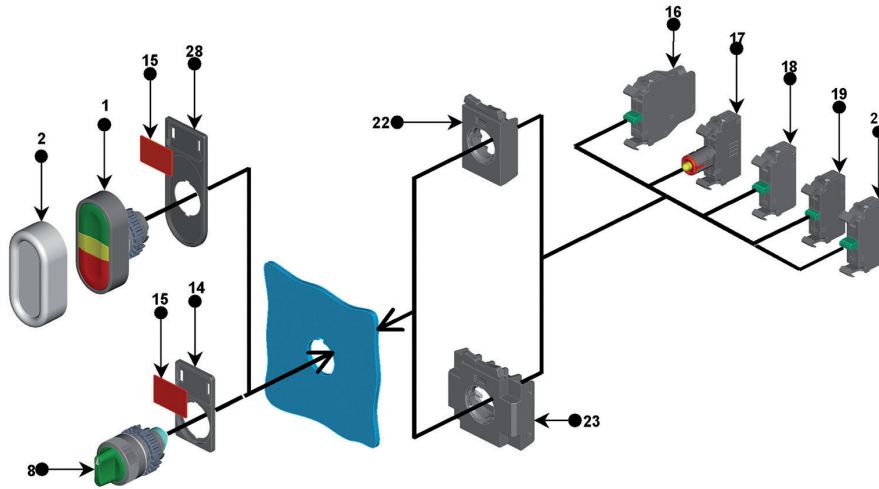

PUSHBUTTONS



Controls

Pushbuttons and Pilot Lights - CSW Series (22mm)

Pushbuttons

Types

- F - Flush
- S - Extended
- C - Mushroom
- D - Double
- GA - Recessed
- FI - Illuminated Flush
- SI - Illuminated Extended
- CI - Illuminated Mushroom

CSW-B

MULTIPLIER SYMBOL FOR CSW SERIES - Z5

Color (see Color Code)

<p>FLUSH</p> <p>CSW-__</p> <ul style="list-style-type: none"> ○ BF0 ● BF1 ● BF2 ● BF3 ● BF4 ● BF5  <p>LIST PRICE \$6.80</p>	<p>NON-ILLUMINATED² (Extended)</p> <p>CSW-__</p> <ul style="list-style-type: none"> ● BS1 ● BS2  <p>LIST PRICE \$9.00</p>	<p>MUSHROOM (40mm HEAD)</p> <p>CSW-__</p> <ul style="list-style-type: none"> ● BC1 ● BC2  <p>LIST PRICE \$11.00</p>	<p>RECESSED</p> <p>CSW-__</p> <ul style="list-style-type: none"> ○ BGA0 ● BGA1 ● BGA2 ● BGA3 ● BGA4 ● BGA5  <p>LIST PRICE \$7.00</p>
<p>ILLUMINATED FLUSH</p> <p>CSW-__</p> <ul style="list-style-type: none"> ○ BFI0 ● BFI1 ● BFI2 ● BFI3 ● BFI4  <p>LIST PRICE \$11.20</p>	<p>ILLUMINATED EXTENDED</p> <p>CSW-__</p> <ul style="list-style-type: none"> ○ BSI0 ● BSI1 ● BSI2 ● BSI3 ● BSI4  <p>LIST PRICE \$11.00</p>	<p>ILLUMINATED MUSHROOM (40mm HEAD)</p> <p>CSW-__</p> <ul style="list-style-type: none"> ○ BC10 ● BC11 ● BC12 ● BC13 ● BC14  <p>LIST PRICE \$13.00</p>	<p>DOUBLE¹</p> <p>CSW-BD</p>  <p>LIST PRICE \$15.30</p> <p>(IP40)⁽¹⁾</p>

Emergency-Stop Pushbuttons

CSW-B E

Types

- G - Twist release
- Y - Key release

<p>E-STOP - TWIST RELEASE</p> <p>● CSW-BEG</p>  <p>LIST PRICE \$16.10</p>	<p>E-STOP - KEY RELEASE</p> <p>● CSW-BEY</p>  <p>LIST PRICE \$48.00</p>
---	---

Pilot Lights

CSW-S D

Color (see Color Code)

PILOT LIGHTS

CSW-__

- SD0
- SD1
- SD2
- SD3
- SD4



LIST PRICE \$9.40

COLOR CODE

Color	Clear/White	Red	Green	Yellow	Blue	Black
Code	0	1	2	3	4	5
Symbol	○	●	●	●	●	●

(1) For increasing the degree of protection to IP66, use the protection cover APBD.
 (2) UL Pending.



PUSHBUTTONS

Controls

Pushbuttons and Pilot Lights - CSW Series (22mm)

Selector Switches

Types

K - Knob

A - Lever

Y - Key

KI - Illuminated Knob

CSW-C

No. of Positions

2 - Two positions

3 - Three positions

Color code for illuminated selectors switched (see Color Code)

Angle
45 - 45°
90 - 90°

Handle

F - Maintained

R - Spring return

RE - Spring return from left

RD - Spring return from right

Knob	Lever	with KEY (1)	ILLUMINATED	POSITION	DIAGRAM
LIST PRICE Maintained \$15.00 Spring Return \$17.00	LIST PRICE Maintained \$16.00 Spring Return \$18.00	LIST PRICE Maintained \$46.00 Spring Return \$49.00	LIST PRICE Maintained \$11.50 Spring Return \$13.00		
CSW-CK2F45	CSW-CA2F45	CSW-CY2F45			1
CSW-CK2R45	CSW-CA2R45	CSW-CY2R45			1
CSW-CK2F90	CSW-CA2F90	CSW-CY2F90	CSW-CKI2F90*		2
CSW-CK2R90	CSW-CA2R90	CSW-CY2R90			2
CSW-CK3F45	CSW-CA3F45	CSW-CY3F45	CSW-CKI3F45*		3
CSW-CK3R45	CSW-CA3R45	CSW-CY3R45	CSW-CKI3R45*		3
CSW-CK3RE45	CSW-CA3RE45	CSW-CY3RE45	CSW-CKI3RE45*		3
CSW-CK3RD45	CSW-CA3RD45	CSW-CY3RD45	CSW-CKI3RD45*		3

* To complete selection, replace "*" with desired color from table below.

(1) Key is released on any position.

Substitute **CY** by **CYD** for key release just on the right.

Substitute **CY** by **CYE** for key release just on the left.

Substitute **CY** by **CYC** for key release just on the center.

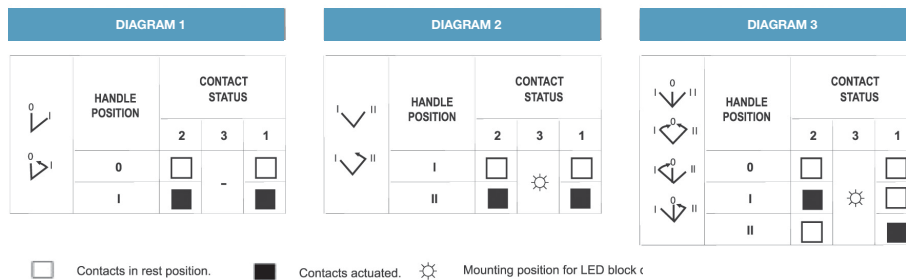

Color Code



Color	Clear/White	Red	Green	Yellow	Blue	Black
Code	0	1	2	3	4	5
Symbol	○	●	●	●	●	●







Controls

Pushbuttons and Pilot Lights - CSW Series (22mm)



Auxiliary Contact Blocks

Single		Double	
<p>BC01-CSW - 1NC BC10-CSW - 1NO</p> <p>LIST PRICE \$5.00</p> 	<p>BCA10-CSW - 1NOem (early make) BCR01-CSW - 1NCdb (delayed break)</p> <p>LIST PRICE \$6.00</p> 	<p>BC11-CSW - 1NO/1NC BC20-CSW - 2NO</p> <p>LIST PRICE \$9.50</p> 	

Lamp Blocks

Full Voltage AC / DC	Resistor + Diode (220 VAC)	Lamps Incandescent (BA9S)															
<p>CSW-BID</p> <p>LIST PRICE \$5.10</p>  <p>- For Ba9s lamps 380V / 2W max.</p>	<p>CSW-BIRDD66</p> <p>LIST PRICE \$26.70</p>  <p>- Incandescent lamp included (130V, Ba9s)</p>	<table border="0"> <tr> <td>CSW-LI E48-0 - 6W</td> <td>6V 50-60Hz/DC</td> <td rowspan="7"> <p>LIST PRICE \$9.70</p>  </td> </tr> <tr> <td>CSW-LI E25-1 - 8W</td> <td>12V 50-60Hz/DC</td> </tr> <tr> <td>CSW-LI E26 - 2W</td> <td>24V 50-60Hz/DC</td> </tr> <tr> <td>CSW-LI E27 - 2W</td> <td>48V 50-60Hz/DC</td> </tr> <tr> <td>CSW-LI E28-1 - 2W</td> <td>60V 50-60Hz/DC</td> </tr> <tr> <td>CSW-LI E30 - 2W</td> <td>130V 50-60Hz/DC</td> </tr> <tr> <td>CSW-LI E31 - 2W</td> <td>220V 50-60Hz/DC (Neon)</td> </tr> </table>	CSW-LI E48-0 - 6W	6V 50-60Hz/DC	<p>LIST PRICE \$9.70</p> 	CSW-LI E25-1 - 8W	12V 50-60Hz/DC	CSW-LI E26 - 2W	24V 50-60Hz/DC	CSW-LI E27 - 2W	48V 50-60Hz/DC	CSW-LI E28-1 - 2W	60V 50-60Hz/DC	CSW-LI E30 - 2W	130V 50-60Hz/DC	CSW-LI E31 - 2W	220V 50-60Hz/DC (Neon)
CSW-LI E48-0 - 6W	6V 50-60Hz/DC	<p>LIST PRICE \$9.70</p> 															
CSW-LI E25-1 - 8W	12V 50-60Hz/DC																
CSW-LI E26 - 2W	24V 50-60Hz/DC																
CSW-LI E27 - 2W	48V 50-60Hz/DC																
CSW-LI E28-1 - 2W	60V 50-60Hz/DC																
CSW-LI E30 - 2W	130V 50-60Hz/DC																
CSW-LI E31 - 2W	220V 50-60Hz/DC (Neon)																

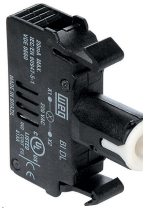
LED Blocks

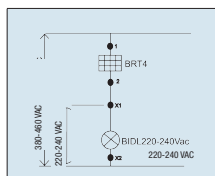
BIDL	BRT Blocks
<p>Colors</p> <ul style="list-style-type: none"> ○ 0 White ● 1 Red ● 2 Green ● 3 Yellow ● 4 Blue <p>CSW-BIDL</p>  <p>LIST PRICE \$16.00</p> <p>For 125Vdc only</p> <p>LIST PRICE \$18.90</p> <p>For 380-460Vac voltage, use BRT block</p> <p>Code Voltage level</p> <ul style="list-style-type: none"> E25 = 12Vac/Vdc E26 = 24Vac/Vdc E27 = 48Vac/Vdc D61 = 110-130Vac C13 = 125Vdc D66 = 220-240Vac 	<p>For 460 Vac CSW-BRT-D85 (used with BIDL_D66)</p>  <p>LIST PRICE \$9.80</p> 

PUSHBUTTONS



Controls

Pushbuttons and Pilot Lights - CSW Series (22mm)

Special Operators

POTENTIOMETER

CSW-POT_W

LIST PRICE
\$128.00



CSW-POT **W**

Resistance

05 - 0.5kΩ	10 - 10kΩ
1 - 1kΩ	25 - 25kΩ
2 - 2kΩ	1M - 1MΩ
5 - 5kΩ	

RESET

CSW-RSBF

	Without markings	With markings
	LIST PRICE \$17.00	LIST PRICE \$20.00

- RSBF0
- RSBF1
- RSBF4
- RSBF5
- RSBF6



CSW-RSBF

Color (see Color Code)

Markings

- blank** - no markings
- O** - Letter "O"
- R** - Letter "R"
- RT** - Word "reset"

Note: Plunger included as standard.

Push On / Push Off Block

BR-3P-CSW

LIST PRICE
\$9.30

- Device for flush, extended and mushroom pushbuttons







Note: Use only with single contact blocks.
1NO-contacts must be BCA10 (early make) type.



Controls

Pushbuttons and Pilot Lights - CSW Series (22mm)

Plate Holder – Legend Plate Included		Flange	
<p>White background</p> <p>Black face</p> <p>Red face</p> <p>Clear</p> <p>LIST PRICE \$2.30</p>	<p>APP30 APP60</p> <p>APP30T</p> 	<p>AF3 3 positions</p> <p>LIST PRICE \$2.50</p> 	<p>AF5 5 positions</p> <p>LIST PRICE \$4.80</p> 
<p>Note: AF3 is always supplied with all operators.</p>			

Legend Plates	Reducer Ring	Emergency Pushbutton Protection
<p>White background</p> <p>Black face</p> <p>Red face</p> <p>Clear</p> <p>LIST PRICE \$1.60</p>	<p>AR30</p> <p>Drilling reduction 30mm to 22mm</p> <p>LIST PRICE \$4.25</p> 	<p>APEG</p> <p>LIST PRICE \$10.00</p> 

Blank ID Plate

APN

LIST PRICE
\$0.60



Emergency Plate

APE-03

LIST PRICE
\$8.30



Tools

ACEF Lamp extractor

LIST PRICE
\$5.60



CPAW Fixing tool

LIST PRICE
\$5.60



Protective Covers

APBF for flush pushbuttons

LIST PRICE
\$7.70



APBD for double pushbutton

LIST PRICE



Lens for Pilot Lights

- ALSD0
- ALSD1
- ALSD2
- ALSD3
- ALSD4

LIST PRICE
\$2.10



Hole Plug

ATR

LIST PRICE
\$4.90



PUSHBUTTONS





Controls Pushbuttons and Pilot Lights - CSW Series (22mm)

Engraved Legend Plates

Catalog Number	Message	Description	List Price Package with 5 units
For Pushbuttons & Indicating Lights			
APP30-01	Close	22mm Legend Plate & Holder - Close	\$21.00
APP30-02	Down	22mm Legend Plate & Holder - Down	\$21.00
APP30-03	Emergency Stop	22mm Legend Plate & Holder - Emergency Stop	\$21.00
APP30-04	Forward	22mm Legend Plate & Holder - Forward	\$21.00
APP30-05	Jog	22mm Legend Plate & Holder - Jog	\$21.00
APP30-06	Jog Forward	22mm Legend Plate & Holder - Jog Forward	\$21.00
APP30-07	Jog Reverse	22mm Legend Plate & Holder - Jog Reverse	\$21.00
APP30-08	Lower	22mm Legend Plate & Holder - Lower	\$21.00
APP30-09	Off	22mm Legend Plate & Holder - Off	\$21.00
APP30-10	On	22mm Legend Plate & Holder - On	\$21.00
APP30-11	Open	22mm Legend Plate & Holder - Open	\$21.00
APP30-12	Power On	22mm Legend Plate & Holder - Power On	\$21.00
APP30-13	Raise	22mm Legend Plate & Holder - Raise	\$21.00
APP30-14	Reset	22mm Legend Plate & Holder - Reset	\$21.00
APP30-15	Reverse	22mm Legend Plate & Holder - Reverse	\$21.00
APP30-16	Run	22mm Legend Plate & Holder - Run	\$21.00
APP30-17	Start	22mm Legend Plate & Holder - Start	\$21.00
APP30-18	Stop	22mm Legend Plate & Holder - Stop	\$21.00
APP30-19	Up	22mm Legend Plate & Holder - Up	\$21.00
APP30-147	Fault	22mm Legend Plate & Holder - Fault	\$21.00
For two-position Selector Switch			
APP30-20	Forward Reverse	22mm Legend Plate & Holder - Forward Reverse	\$21.00
APP30-21	Hand Auto	22mm Legend Plate & Holder - Hand Auto	\$21.00
APP30-22	Jog Run	22mm Legend Plate & Holder - Jog Run	\$21.00
APP30-23	Manual Auto	22mm Legend Plate & Holder - Manual Auto	\$21.00
APP30-24	Off On	22mm Legend Plate & Holder - Off On	\$21.00
APP30-25	Open Close	22mm Legend Plate & Holder - Open Close	\$21.00
APP30-26	Run Jog	22mm Legend Plate & Holder - Run Jog	\$21.00
APP30-27	Start Stop	22mm Legend Plate & Holder - Start Stop	\$21.00
APP30-28	Up Down	22mm Legend Plate & Holder - Up Down	\$21.00
For three-position Selector Switch			
APP30-29	Auto Off Hand	22mm Legend Plate & Holder - Auto Off Hand	\$21.00
APP30-30	For Off Rev	22mm Legend Plate & Holder - For Off Rev	\$21.00
APP30-31	Hand Off Aut	22mm Legend Plate & Holder - Hand Off Aut	\$21.00
APP30-32	Man Off Auto	22mm Legend Plate & Holder - Man Off Auto	\$21.00
APP30-33	Open Off Auto	22mm Legend Plate & Holder - Open Off Auto	\$21.00
APP30-34	Open Off Close	22mm Legend Plate & Holder - Open Off Close	\$21.00
APP30-35	Up Off Down	22mm Legend Plate & Holder - Up Off Down	\$21.00
APP30-149	Auto Off Rev	22mm Legend Plate & Holder - Auto Off Rev	\$21.00
APP30-198	Low Med High	22mm Legend Plate & Holder - Low Med High	\$21.00
APP30-199	Low Off High	22mm Legend Plate & Holder - Low Off High	\$21.00
For Push/Pull units			
APP30-36	ON/OFF	22mm Legend Plate & Holder - ON/OFF	\$21.00
APP30-37	OPEN/CLOSE	22mm Legend Plate & Holder - OPEN/CLOSE	\$21.00
APP30-38	UP/DOWN	22mm Legend Plate & Holder - UP/DOWN	\$21.00
For Potentiometers ¹⁾			
APP30-P00	0 - 100	22mm Legend Plate & Holder - (Blank 0 - 100)	\$6.00
APP30-P01	0 - 10	22mm Legend Plate & Holder - (Blank 1 - 10)	\$6.00
APP30-P02	Speed 0 - 10	22mm Legend Plate & Holder - (Speed 1 - 10)	\$6.00
APP30-P03	Speed 0 - 100	22mm Legend Plate & Holder - (Speed 1 - 100)	\$6.00

¹⁾ Package with 1 unit.

PUSHBUTTONS



Controls

Pushbuttons and Pilot Lights - CSW Series (22mm)

Standards	IEC/EN 60947-5-1, VDE 0660, NFC63140, UL 508, UL 50, CENELEC EN50007	
Rated insulation voltage	660 Vac / Vdc	
Degree of protection	IP66 (IEC/EN 60529)	
Degree of protection - Terminals	IP2X (IEC/EN 60529)	
UL ratings	Type 1, 2, 3, 3R, 35, 4, 4X, 5,12, 12K e 13	
Electrical ratings		
Conventional thermal current	I _{th} = 10A (IEC 947-5-1)	
Utilization category AC-15	(V)	(A)
	24	10
	48	10
	60	10
	110	6
	230	3
	400	2
	500	1,5
	600	1,2
Utilization category DC-13	(V)	(A)
	24	2,5
	48	1,4
	60	1
	110	0,55
	230	0,27
	400	0,2
	600	0,1
UL / CSA ratings	AC / Heavy Duty (A600) DC / Standard Duty (Q600)	
Contacts resistance	≤ 25mΩ (IEC/EN 60255)	
Short circuit protection	16A gL/gG fuse or MPW25-10	
Electrical shock protection	Class II	
Rated impulse voltage	2,5 kV (IEC 947-5-1)	
Terminal capacity	1 or 2 x (0.5 - 2.5mm ²) / 1 or 2 x 14-20AWG	
Temperature range	-25°C to 70°C (-13°F to 158°F)	
Shock resistance	No damage or disassembling at 100g for all devices	
According to MIL 202 Bmethod 202A ≤ ½ sinusoid 11ms		
Vibration resistance	16g with frequency range from 40 to 500Hz and max shifting 0,75mm (peak-to-peak)	
IEC/EN 6068-2-6		
Mechanical endurance	3 x 10 ⁶	
Pushbuttons		
Selector Switches	1 x 10 ⁶	
Emergency-Stop	3 x 10 ⁵	
Maximum number of contacts	AF3 Flange	AF5 Flange
Pushbuttons (BF)	Max. 6	Max 10

BIDL Block Ratings

Rated operational voltage	0,85 ~1,10 x V
Rated current	20 mA
Rated impulse voltage	2,5 kV (IEC 947-5-1)
Temperature range	- 25 to 70°C (-73°F to 158°F)
Life	100.000 h
Luminosity	Red: 70 mcd
	Yellow: 115 mcd
	White: 275 mcd
	Blue: 64 mcd
	Green: 150 mcd



Controls

Pushbuttons and Pilot Lights - CSW Series (22mm)

Dimensions (mm)

Pushbuttons

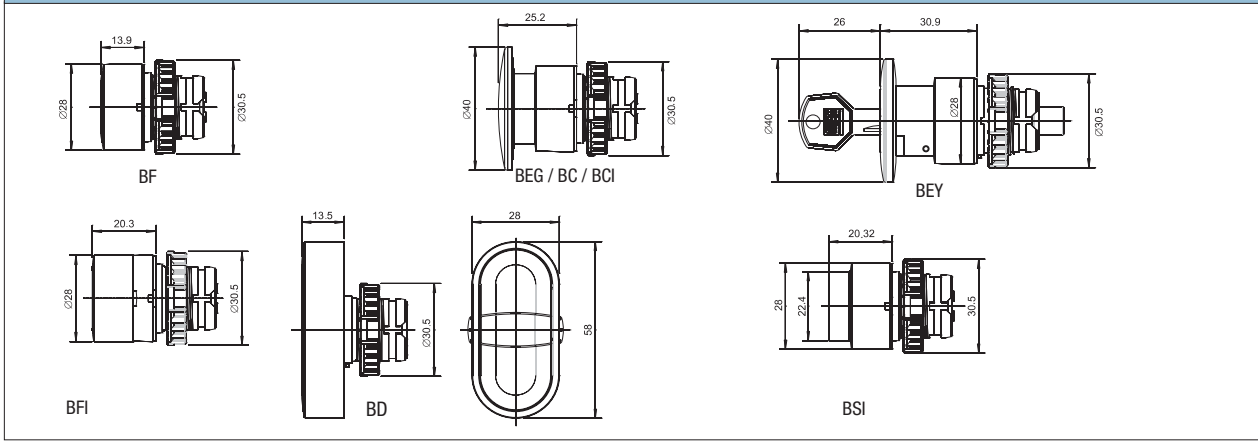

Pilot Lights

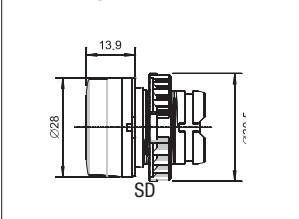

LED and Lamp Blocks

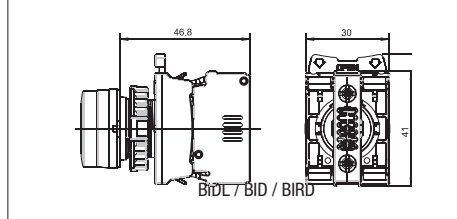

Drilling

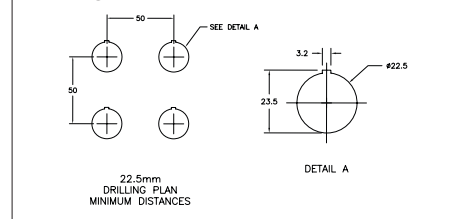

Selector Switches

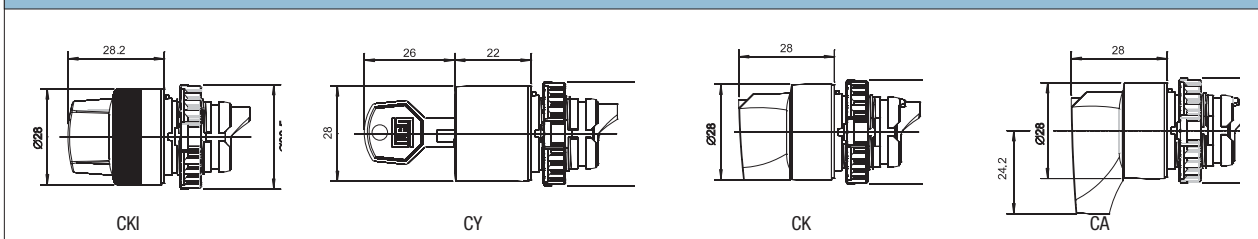

Contact Blocks

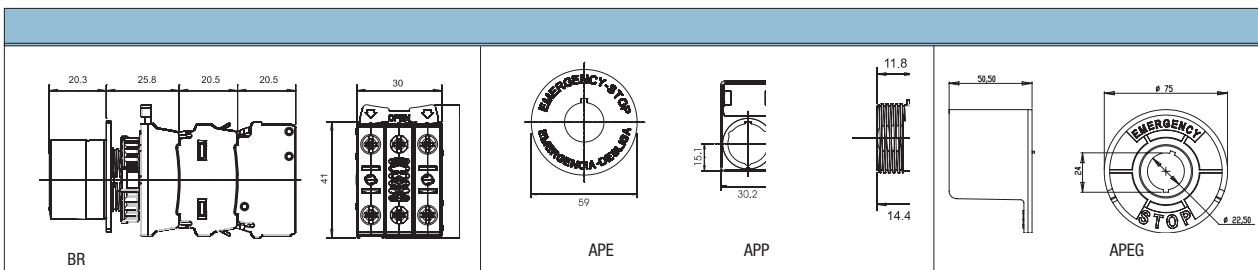
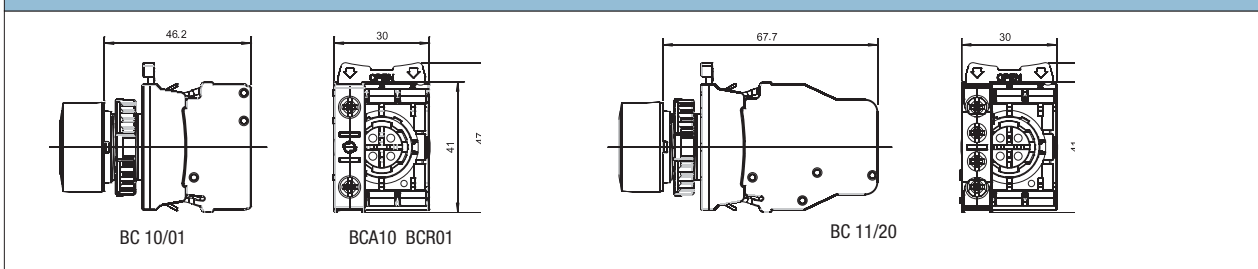

PUSHBUTTONS

Controls

Pushbutton and Pilot Light - CSW30 Series (30mm)

The WEG 30mm pushbuttons, selector switches, and indicators have been designed to offer the ruggedness required for severe industrial applications and environments. These modular devices offer superior quality at an affordable price.

Our hazardous duty series CSW30H also offers a wide selection of operators and pilot devices for hazardous duty applications (Class 1, Division 2 and Zone 2). This series offers a wide selection of hermetically sealed reed and factory sealed contact blocks for superior corrosion resistance.

- NEMA 4, IP65 Rated;
- Fits 1-13/64 (30.5mm) hole without notch required ;
- Contact blocks snap-in (fast & easy assembly);
- Up to 8 contact blocks for non-illuminated operators and up to 4 contact blocks for illuminated operators
- LED lamps with built-in leakage protection;
- Same simple part numbering system as 22mm series.

Industrial Duty - CSW30 Series

UL listed and rated 4 / 4X for watertight and corrosion resistance



Hazardous Duty - CSW30H Series

Specially engineered for Class 1, Division 2 and Zone 2



Certifications



Controls

Pushbutton and Pilot Light - CSW30 Series (30mm)

Pushbuttons

Types

- F - Flush
- S - Extended
- C - Mushroom
- GA - Recessed
- GAI - Illuminated Recessed
- SI - Illuminated Extended
- CI - Illuminated Mushroom

MULTIPLIER SYMBOL FOR CSW-30 SERIES - Z55

CSW30-B

Voltage (see Voltage Code) For illuminated only
 Color (see Color Code)

FLUSH

CSW30 - _

- BF0
- BF1
- BF2
- BF3
- BF4
- BF5



LIST PRICE \$26.00

NON-ILLUMINATED (Extended)

CSW30 - _

- BS0
- BS1
- BS2
- BS3
- BS4
- BS5



LIST PRICE \$26.00

MUSHROOM (40mm HEAD)

CSW30 - _

- BC1
- BC2
- BC5



LIST PRICE \$37.00

RECESSED

CSW30 - _

- BGA0
- BGA1
- BGA2
- BGA3
- BGA4
- BGA5



LIST PRICE \$32.00

ILLUMINATED EXTENDED

CSW30 - _ *

- BS10
- BS11
- BS12
- BS13
- BS14



LIST PRICE \$93.00

ILLUMINATED MUSHROOM (40mm HEAD)

CSW30 - _ *

- BC10
- BC11
- BC12
- BC13
- BC14



LIST PRICE \$100.00

ILLUMINATED RECESSED

CSW30 - _ *

- BGA10
- BGA11
- BGA12
- BGA13
- BGA14



LIST PRICE \$100.00

* Illuminated operators are supplied with LED block. To complete selection, replace "*" with desired voltage: E26 (24Vac/Vdc), D61 (120Vac/Vdc) or D66 (240Vac/Vdc).

Emergency-Stop Pushbuttons

Types

- G - Twist release

CSW-B E

E-STOP - TWIST RELEASE

- CSW30-BEG
- CSW30-BEG2



LIST PRICE \$81.00

E-STOP - PUSH PULL

- CSW30-BEP
- CSW30-BEP2



LIST PRICE \$75.00

Pilot Lights

CSW30-S D

Voltage (see Voltage Code)
 Color (see Color Code)

PILOT LIGHTS

CSW30 - _ *

- SD0
- SD1
- SD2
- SD3
- SD4



LIST PRICE \$89.00

Code Chart

Color	Clear/White	Red	Green	Yellow	Blue	Black
Code	0	1	2	3	4	5
Symbol	○	●	●	●	●	●

LED Block Voltage	
E26	24Vac/Vdc
D61	120Vac/Vdc
D66	240Vac/Vdc



Controls

Pushbutton and Pilot Light - CSW30 Series (30mm)

Selector Switches

Types

K - Knob

A - Lever

Y - Key

CSW30-C

No. of Positions

2 - Two positions

3 - Three positions

4 - Four positions

Angle

45 - 45°

90 - 90°



Handle

F - Maintained

R - Spring return

RE - Spring return from left

RD - Spring return from right

Knob	Lever	with KEY ⁽¹⁾	POSITION	DIAGRAM
 <p>LIST PRICE Maintained \$39.00 Spring Return \$57.00</p>	 <p>LIST PRICE Maintained \$39.00 Spring Return \$57.00</p>	 <p>LIST PRICE Maintained \$110.00 Spring Return \$128.00</p>		
CSW30-CK2F90	CSW30-CA2F90	CSW30-CY2F90		1
CSW30-CK2R90	CSW30-CA2R90	CSW30-CY2R90		1
CSW30-CK3F45	CSW30-CA3F45	CSW30-CY3F45		2
CSW30-CK3R45	CSW30-CA3R45	CSW30-CY3R45		2
CSW30-CK3RE45	CSW30-CA3RE45	CSW30-CY3RE45		2
CSW30-CK3RD45	CSW30-CA3RD45	CSW30-CY3RD45		2
CSW30-CK4F18	CSW30-CA4F18	CSW30-CY4F18		3

¹⁾ Key is released on any position. Consult WEG for other configuration.

HANDLE POSITION		Auxiliary Contact	Mouting Position
I	II		
0	X	NO	Either
X	0	NC	Either
0	X	early make	Either
X	0	late break	Either

X = CLOSED
0 = OPEN

HANDLE POSITION			Auxiliary Contact	Mouting Position
I	0	II		
X	0	0	NO	Left
0	0	X	NO	Right
0	X	0	NC	Either
X	0	X	early make	Either
0	X	X	late break	Left
X	X	0	late break	Right

HANDLE POSITION				Auxiliary Contact	Mouting Position
I	II	III	IV		
X	0	0	0	NO	Left
0	0	0	X	NO	Right
0	0	X	0	NC	Left
0	X	0	0	NC	Right
X	X	0	X	early make	Left
X	0	X	X	early make	Right
0	X	X	X	late break	Left
X	X	X	0	late break	Right

PUSHBUTTONS



Controls

Pushbutton and Pilot Light - CSW30 Series (30mm)

Auxiliary Contacts

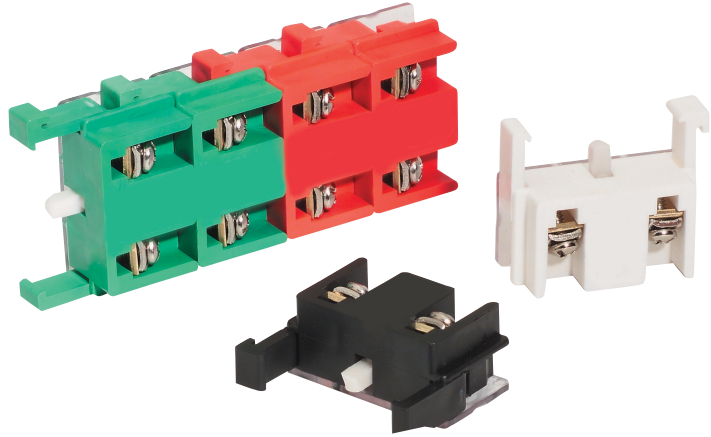
Our standard contact blocks are color coded for easy circuit identification to minimize wiring errors. WEG's contact blocks are stackable up to 4 deep (for a total of up to 8 circuits per operator) without the need of any additional accessory. Combining different contact blocks types enable several functions to be achieved.

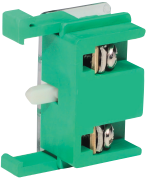
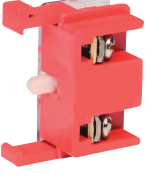
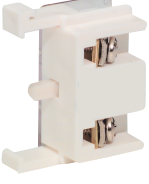

CONTACT BLOCKS			
Normally Open BC10-CSW30 	LIST PRICE \$13.00	Normally Closed BC01-CSW30 	LIST PRICE \$13.00
Early Make BCA10-CSW30 	LIST PRICE \$17.00	Late Break BCR01-CSW30 	LIST PRICE \$17.00

Accessories

CLAMP RING WRENCH

CPAW30



LIST PRICE
\$30.00

Simplifies the tightening or loosening of polyester and aluminum 1-3/8" clamp rings.

30MM HOLE PLUG

ATR30



LIST PRICE
\$25.00

NEMA 4X rated plug to seal up unwanted panel holes.

THRUST AND TRIM WASHER

CSW30-TT30



LIST PRICE
\$4.00

Anti-rotation ring

EMERGENCY PLATE

APE30-03



LIST PRICE
\$10.00

PANEL GASKETS

CSW30-PG2 (1/16')
CSW30-PG6 (3/16')



LIST PRICE
\$10.00



Controls

Pushbutton and Pilot Light - CSW30 Series (30mm)

Special Operators

POTENTIOMETER

CSW30-POT_W

LIST PRICE
\$145.00

CSW30-POT	W	Resistance	
		1 - 1kΩ	10 - 10kΩ
		2 - 2kΩ	50 - 50kΩ
		5 - 5kΩ	

RESET

CSW30-RSBW

LIST PRICE
22.00

PUSH ON / PUSH OFF BLOCK

BR3P-CSW30

LIST PRICE
\$37.00

Note: Plunger included as standard.

WOBBLE STICK

CSW30-WS

LIST PRICE
\$65.00

BOOTED CABLE PULL

CSW30-CPBT

LIST PRICE
\$130.00

LED Bulbs



Part Number	Description	List Price
CSW30-BIDL3E26	Yellow 24vac/24vdc	\$28.00
CSW30-BIDL4E26	Blue 24vac/24vdc	\$28.00
CSW30-BIDL2E26	Green 24vac/24vdc	\$28.00
CSW30-BIDL1E26	Red 24vac/24vdc	\$28.00
CSW30-BIDL0E26	White 24vac/24vdc	\$28.00
CSW30-BIDL3D61	Yellow 120vac/120vdc	\$28.00
CSW30-BIDL4D61	Blue 120vac/120vdc	\$28.00
CSW30-BIDL2D61	Green 120vac/120vdc	\$28.00
CSW30-BIDL1D61	Red 120vac/120vdc	\$28.00
CSW30-BIDL0D61	White 120vac/120vdc	\$28.00

Replacement LED bulbs for 240Vac/Vdc illuminated operators are the "E26" (24Vac/Vdc) bulbs. Please refer to the correct color when ordering.

PUSHBUTTONS





Controls

Pushbutton and Pilot Light - CSW30 Series (30mm)

Engraved Legend Plates

Catalog Number	Marking	Description	List Price Package with 1 unit
For Pushbuttons & Indicating Lights			
APP30S-01	Close	30mm Legend Plate & Holder - Close	\$6.00
APP30S-02	Down	30mm Legend Plate & Holder - Down	\$6.00
APP30S-03	Emergency Stop	30mm Legend Plate & Holder - Emergency Stop	\$6.00
APP30S-04	Forward	30mm Legend Plate & Holder - Forward	\$6.00
APP30S-05	Jog	30mm Legend Plate & Holder - Jog	\$6.00
APP30S-06	Jog Forward	30mm Legend Plate & Holder - Jog Forward	\$6.00
APP30S-07	Jog Reverse	30mm Legend Plate & Holder - Jog Reverse	\$6.00
APP30S-08	Lower	30mm Legend Plate & Holder - Lower	\$6.00
APP30S-09	Off	30mm Legend Plate & Holder - Off	\$6.00
APP30S-10	On	30mm Legend Plate & Holder - On	\$6.00
APP30S-11	Open	30mm Legend Plate & Holder - Open	\$6.00
APP30S-12	Power On	30mm Legend Plate & Holder - Power On	\$6.00
APP30S-13	Raise	30mm Legend Plate & Holder - Raise	\$6.00
APP30S-14	Reset	30mm Legend Plate & Holder - Reset	\$6.00
APP30S-15	Reverse	30mm Legend Plate & Holder - Reverse	\$6.00
APP30S-16	Run	30mm Legend Plate & Holder - Run	\$6.00
APP30S-17	Start	30mm Legend Plate & Holder - Start	\$6.00
APP30S-18	Stop	30mm Legend Plate & Holder - Stop	\$6.00
APP30S-19	Up	30mm Legend Plate & Holder - Up	\$6.00
APP30S-147	Fault	30mm Legend Plate & Holder - Fault	\$6.00
APP30S-100	Auto	30mm Legend Plate & Holder - Auto	\$6.00
APP30S-101	Fast	30mm Legend Plate & Holder - Fast	\$6.00
APP30S-102	Hand	30mm Legend Plate & Holder - Hand	\$6.00
APP30S-103	Low	30mm Legend Plate & Holder - Low	\$6.00
APP30S-104	Manual	30mm Legend Plate & Holder - Manual	\$6.00
APP30S-105	Out	30mm Legend Plate & Holder - Out	\$6.00
APP30S-106	Overload	30mm Legend Plate & Holder - Overload	\$6.00
APP30S-107	Push-to-Reset	30mm Legend Plate & Holder - Push-to-Reset	\$6.00
APP30S-108	Slow	30mm Legend Plate & Holder - Slow	\$6.00
APP30S-109	Trip	30mm Legend Plate & Holder - Trip	\$6.00
APP30S-148	Motor Run	30mm Legend Plate & Holder - Motor Run	\$6.00
APP30S-149	Power Off	30mm Legend Plate & Holder - Power Off	\$6.00
APP30S-150	Push-to-Test	30mm Legend Plate & Holder - Push-to-Test	\$6.00
APP30S-151	Test	30mm Legend Plate & Holder - Test	\$6.00
For two-position Selector Switch			
APP30S-20	Forward -Reverse	30mm Legend Plate & Holder - Forward Reverse	\$6.00
APP30S-21	Hand - Auto	30mm Legend Plate & Holder - Hand Auto	\$6.00
APP30S-22	Jog - Run	30mm Legend Plate & Holder - Jog Run	\$6.00
APP30S-23	Manual - Auto	30mm Legend Plate & Holder - Manual Auto	\$6.00
APP30S-24	Off - On	30mm Legend Plate & Holder - Off On	\$6.00
APP30S-25	Open - Close	30mm Legend Plate & Holder - Open Close	\$6.00
APP30S-26	Run - Jog	30mm Legend Plate & Holder - Run Jog	\$6.00
APP30S-27	Start - Stop	30mm Legend Plate & Holder - Start Stop	\$6.00
APP30S-28	Up - Down	30mm Legend Plate & Holder - Up Down	\$6.00
APP30S-153	Down - Up	30mm Legend Plate & Holder - Down Up	\$6.00
APP30S-154	Local - Remote	30mm Legend Plate & Holder - Local Remote	\$6.00
APP30S-156	Reverse - Forward	30mm Legend Plate & Holder - Reverse Forward	\$6.00
APP30S-157	Stop - Start	30mm Legend Plate & Holder - Stop Start	\$6.00
APP30S-110	Auto - Hand	30mm Legend Plate & Holder - Auto Hand	\$6.00

PUSHBUTTONS



Controls

Pushbutton and Pilot Light - CSW30 Series (30mm)

Engraved Legend Plates

Catalog Number	Marking	Description	List Price Package with 1 unit
For two-position Selector Switch			
APP30S-111	Auto - Manual	30mm Legend Plate & Holder - Auto Manual	\$6.00
APP30S-112	Fast - Slow	30mm Legend Plate & Holder - Fast Slow	\$6.00
APP30S-113	High - Low	30mm Legend Plate & Holder - High Low	\$6.00
APP30S-114	Inch - Run	30mm Legend Plate & Holder - Inch Run	\$6.00
APP30S-115	Left - Right	30mm Legend Plate & Holder - Left Right	\$6.00
APP30S-116	On - Off	30mm Legend Plate & Holder - On Off	\$6.00
APP30S-119	Raise - Lower	30mm Legend Plate & Holder - Raise Lower	\$6.00
APP30S-120	Slow - Fast	30mm Legend Plate & Holder - Slow Fast	\$6.00
APP30S-121	Summer - Winter	30mm Legend Plate & Holder - Summer Winter	\$6.00
For three-position Selector Switch			
APP30S-29	Auto - Off - Hand	30mm Legend Plate & Holder - Auto Off Hand	\$6.00
APP30S-30	Forward - Off - Reverse	30mm Legend Plate & Holder - For Off Rev	\$6.00
APP30S-31	Hand - Off - Auto	30mm Legend Plate & Holder - Hand Off Aut	\$6.00
APP30S-32	Manual - Off - Auto	30mm Legend Plate & Holder - Man Off Auto	\$6.00
APP30S-33	Open - Off - Auto	30mm Legend Plate & Holder - Open Off Auto	\$6.00
APP30S-34	Open - Off - Close	30mm Legend Plate & Holder - Open Off Close	\$6.00
APP30S-35	Up - Off - Down	30mm Legend Plate & Holder - Up Off Down	\$6.00
APP30S-198	Low - Med - High	30mm Legend Plate & Holder - Low Med High	\$6.00
APP30S-199	Low - Off - High	30mm Legend Plate & Holder - Low Off High	\$6.00
APP30S-158	Down - Off - Up	30mm Legend Plate & Holder - Down Off Up	\$6.00
APP30S-159	Jog - Off - Auto	30mm Legend Plate & Holder - Jog Off Auto	\$6.00
APP30S-160	Raise - Off - Lower	30mm Legend Plate & Holder - Raise Off Lower	\$6.00
APP30S-161	Local - Off - Remote	30mm Legend Plate & Holder - Local Off Remote	\$6.00
APP30S-162	Forward - Auto - Rev	30mm Legend Plate & Holder - Fwd Auto Rev	\$6.00
APP30S-122	Auto - Manual - Off	30mm Legend Plate & Holder - Auto Manual Off	\$6.00
APP30S-123	High - Off - Low	30mm Legend Plate & Holder - High Off Low	\$6.00
APP30S-124	Off - Run - Start	30mm Legend Plate & Holder - Off Run Start	\$6.00
APP30S-125	Off - Start - Run	30mm Legend Plate & Holder - Off Start Run	\$6.00
APP30S-126	Off - 1 - 2	30mm Legend Plate & Holder - Off 1 2	\$6.00
APP30S-127	Slow - Off - Fast	30mm Legend Plate & Holder - Slow Off Fast	\$6.00
APP30S-128	Summer - Off - Winter	30mm Legend Plate & Holder - Summer Off Winter	\$6.00
APP30S-129	1 - Off - 2	30mm Legend Plate & Holder - 1 Off 2	\$6.00
APP30S-130	1 - 2 - 3	30mm Legend Plate & Holder - 1 2 3	\$6.00
For Push/Pull units			
APP30S-36	On - Off	30mm Legend Plate & Holder - On / Off	\$6.00
APP30S-37	Open - Close	30mm Legend Plate & Holder - Open / Close	\$6.00
APP30S-38	Up - Down	30mm Legend Plate & Holder - Up / Down	\$6.00
APP30S-152	Pull Start - Push Stop	30mm Legend Plate & Holder - Pull Start / Push Stop	\$6.00
APP30S-155	Push to Stop - Pull to Start	30mm Legend Plate & Holder - Push to Stop / Pull to Start	\$6.00
APP30S-117	Push Off - Pull On	30mm Legend Plate & Holder - Push Off / Pull On	\$6.00
APP30S-118	Push On - Push Off	30mm Legend Plate & Holder - Push On / Push Off	\$6.00
For Potentiometers			
APP30S-P00	0 - 100	30mm Legend Plate & Holder - (Blank 0 - 100)	\$6.00
APP30S-P01	0 - 10	30mm Legend Plate & Holder - (Blank 1 - 10)	\$6.00
APP30S-P02	Speed 0 - 10	30mm Legend Plate & Holder - (Speed 1 - 10)	\$6.00
APP30S-P03	Speed 0 - 100	30mm Legend Plate & Holder - (Speed 1 - 100)	\$6.00



Controls

Pushbutton and Pilot Light - CSW30 Series (30mm)

Technical Data

ELECTRICAL RATINGS - 30MM INDUSTRIAL PILOT DEVICES

Lamp	Industry Number	Rated Volts	Lumens (MSCD)	Design Life (Hrs.)	Current Draw (mA)	Lamp Type	Shock & Vibration	Leakage Protection
BIDL6	**	6V		100,000	50	LED	Excellent	14 mA
BIDL12	**	12V	Varies w/ Color	100,000	<20	LED	Excellent	4 mA
BIDL24	**	24V	Varies w/ Color 2000 mcd	100,000	<20	LED	Excellent	4 mA
BIDL130	**	120/130V	Typical	100,000	<10	LED	Excellent	2 mA

*Specify lamp color when ordering.

DIELECTRIC STRENGTH (TERMINAL TO GROUND) 2200V for 1 Minute

STANDARD CONTACTS	Utilization Category	IEC	UL	Make Rating	Break Rating	Ith-Thermal Current
	AC	AC-15	A600	7200VA	720VA	10A
	DC	DC-13	P300	138VA	138VA	5A

Note: For AC voltage below 72V AC the max. allowed switching current is 10A = Ith. For DC voltages below 28V DC the max. allowed switching current is 5A = Ith. For switching applications below 24V/40mA - Hermetic REED contacts are recommended. Hermetic Reeds are also excellent in environments containing chemical vapors, oxidizing agents, and explosive gases. Please refer to the HAZARDOUS section of the 30mm devices for more information.

ENVIRONMENTAL RATINGS
TYPE 1, 2, 3, 3R, 4/4X, 12, 13, and IP65
Operating Temperature -40 to +131° F (-40 to +55° C)
Storage Temperature -40 to +185° F (-40 to +85° C)
Operating environments below freezing temperatures are assumed to be absent of freezing liquids or pollutants.

TERMINAL & WIRING CONSIDERATION
Wire- AWG 22-12 CU (Copper Only – Solid & Stranded) [.5 ~ 4 mm ²] One or Two wires permitted per termination
Recommended Tightening Torque 7 lb-in (+3.0/-0.0 lb-in) — [.8 Nm]

MECHANICAL DESIGN LIFE CYCLES	
Push Buttons	
Momentary	5,000,000
Maintained	250,000
Selector Switches	500,000
All Other Devices	250,000
Standard Contact Blocks	10,000,000
Indicating Lights – Refer to the appropriate Lamp Data	

MATERIALS
Thermoplastic Polyester and Polyester Blends (UV Stabilized for outdoor use)
Operator Housings
Operator Caps and Handles - Non-Illuminated (Glass Reinforced Grades)
Mounting Rings and Nuts
Thrust Washer
Trim Washer
High Impact Polycarbonate (UV Stabilized for outdoor use)
Pilot Light Lens
Transparent PB and Mushroom Caps
Custom Polymers
Certain CAM and Bearing parts are Teflon, Silicone, & Moly-Disulfide Impregnated for improved wearability
Fluorosilicone and Thermoplastic Neoprene Boot Accessories
Seals
Neoprene Gaskets
Thermoplastic – Molded Neoprene and alloy derivatives
BUNA N – Rubber – Teflon Coated
Thermoplastic – Elastomer Molded Seals
Fluorosilicone – Boots
Metal: Brass & Stainless Steel
Push Pull Bushings
Internal tubes for Maintained Devices
Detents for Maintained Devices
Springs (Stainless Steel throughout)
Aluminum
Optional Mounting Nut

OPERATING FORCES	
Pushbuttons (Operator Only)	
Momentary	1.3 lbs. [5.8 N]
Illuminated Momentary	2.8 lbs. [12.4 N]
Maintained	4 to 6 lbs. [17.9~26.7 N]
Illuminated Maintained	4.6 lbs. [20.5 N]
Reset Push Button	1.5 lbs. [6.7 N]
Selector Switches	
Maintained	1.7 in-lbs [19 Nm]
Momentary	1.7 in-lbs [19 Nm]
Key Operated	1.7 in-lbs [19 Nm]
Cable Pull	
Standard	4 to 6 lbs. [17.9~26.7 N]
Heavy Duty	13 lbs. [57.8 N]
Push-Twist Release	4.7 lbs. [20.9 N]
Potentiometer	
2 Watt "J" Series	3-12 in-oz. [11 Nm Max.] (300° Rotation)
Standard Contact Blocks	1 lb. [4.45 N]
Indicating Lights	Refer to the appropriate Lamp Data
Multi-Voltage Light	20-240 VAC/VDC (Burden .65W max.)
Transformer	2 VA

PUSHBUTTONS

Controls

Pushbutton and Pilot Light - CSW30 Series

Momentary & Maintained Non-Illuminated Push Buttons

Fully-assembled operators come standard with one 3/16" (4.8mm) and three 1/16" (1.6mm) gaskets.

Non-Illuminated Operator (shown with Flush Cap)

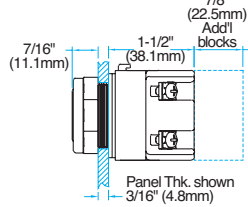

Momentary Flush Cap

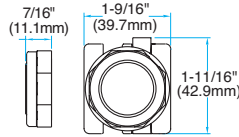

Momentary Guarded Flush Cap

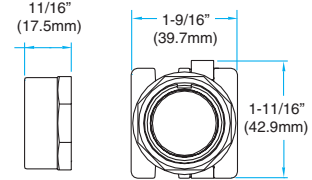

Momentary Extended Cap

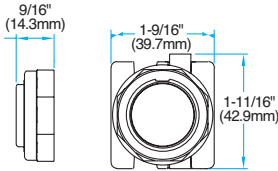

Momentary Guarded Extended Cap

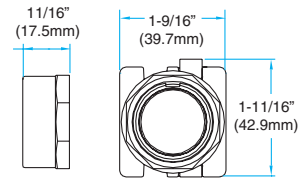

Momentary Standard Rubber Boot

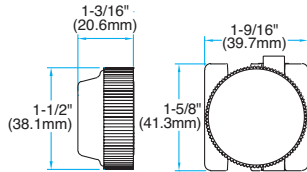

Momentary 1-1/2" (38mm) Mushroom Cap

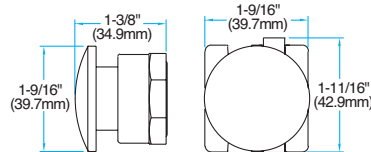

Momentary 2-1/4" (57.2mm) Jumbo Mushroom Cap

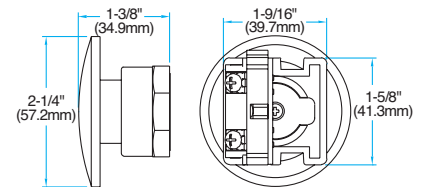

Momentary Fluorosilicone Rubber Boot

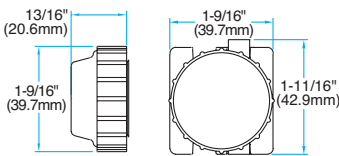

Momentary 1-1/2" (38mm) Shrouded Mushroom Cap

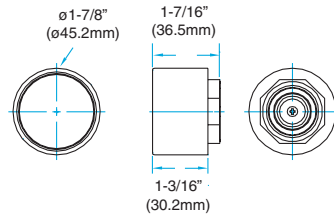

Momentary 2-1/4" (57.2mm) Shrouded Jumbo Mushroom Cap

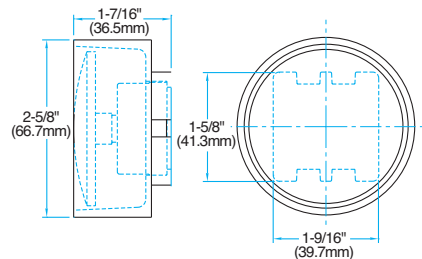

2-Position Push-Pull Maintained 1-1/2" (38mm) Mushroom Cap

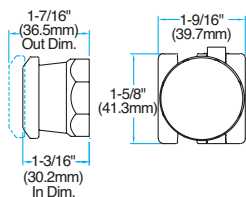

2-Position Push-Pull Maintained 2-1/4" (57.2mm) Jumbo Mushroom Cap

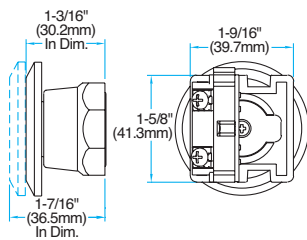

2-Position Push-Twist Maintained 1-1/2" (38mm) Mushroom Cap

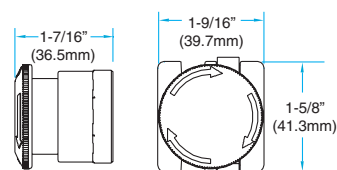

PUSHBUTTONS



Controls

Pushbutton and Pilot Light - CSW30 Series

MOMENTARY ILLUMINATED PUSH BUTTONS

Fully-assembled operators come standard with one 3/16" (4.8mm) and three 1/16" (1.6mm) gaskets.

Illuminated Full Voltage, Transformer, Resistor and Dual-Input Operators

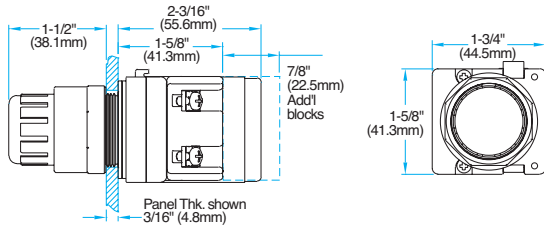

Illuminated Full Voltage Operators

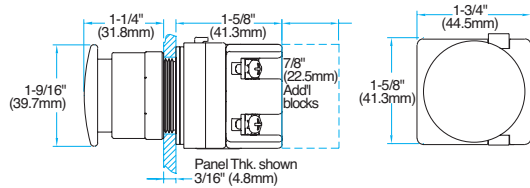

Illuminated Shrouded Mushroom Lens

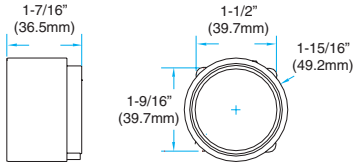

Illuminated Guarded Lens

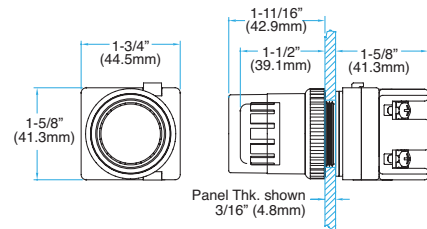

2 & 3 POSITION PUSH-PULL MAINTAINED ILLUMINATED PUSH BUTTONS

Fully-assembled operators come standard with one 3/16" (4.8mm) and three 1/16" (1.6mm) gaskets.

Illuminated Full Voltage Operator

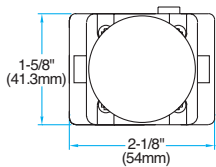
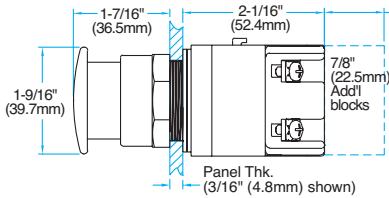

Illuminated Transformer and Resistor Operators

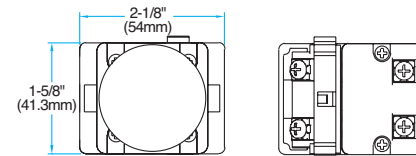
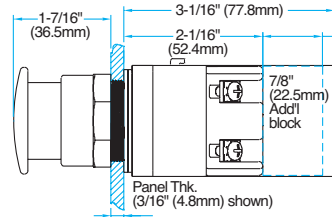

RESET PUSH BUTTON

Fully-assembled operators come standard with one 3/16" (4.8mm) and three 1/16" (1.6mm) gaskets.

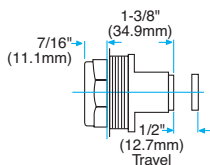

ALTERNATE ACTION BLOCK

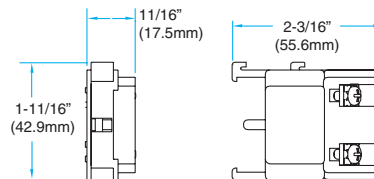

PUSHBUTTONS



Controls

Pushbutton and Pilot Light - CSW30 Series

WOBBLE STICK

Fully-assembled operators come standard with one 3/16" (4.8mm) and three 1/16" (1.6mm) gaskets.

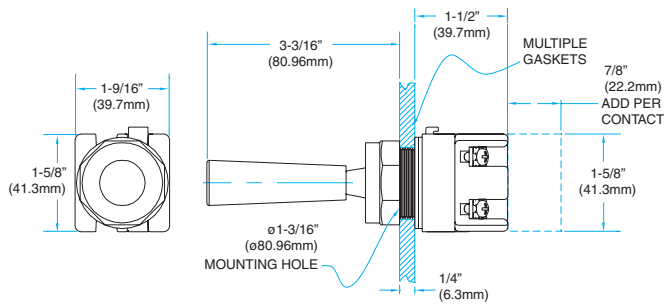

POTENTIOMETER WITH & WITHOUT TERMINAL BLOCK

Fully-assembled operators come standard with one 3/16" (4.8mm) and three 1/16" (1.6mm) gaskets.

Potentiometer Operator (shown without Terminal Block)

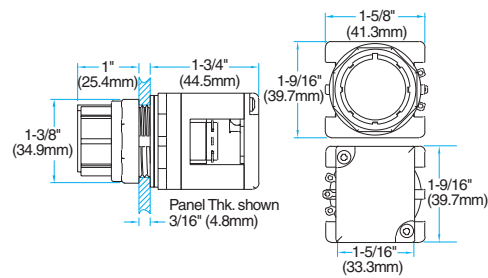

Potentiometer Operator (shown with Terminal Block)

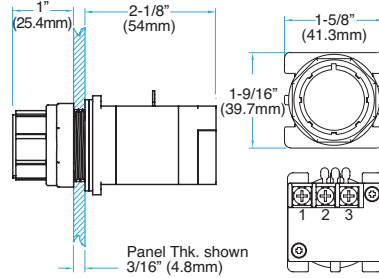

Contact Blocks

CONTACT BLOCK

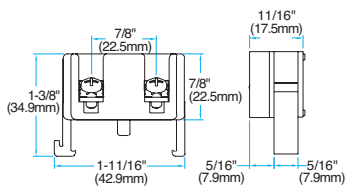

CONTACT BLOCK (SHOWN WITH IP20 TERMINAL GUARD)

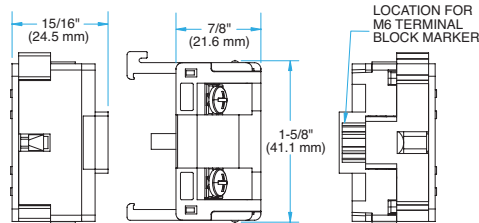

CABLE PULL OPERATORS

Fully-assembled operators come standard with one 3/16" (4.8mm) and three 1/16" (1.6mm) gaskets.

Push-Pull Maintained Cable Pull Operator

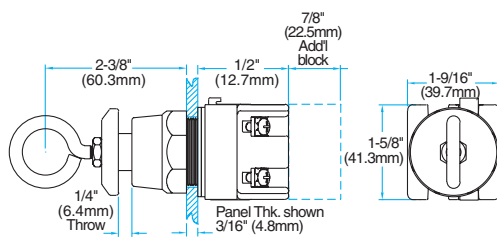

Momentary and Heavy Duty Cable Pull Operators

Momentary Booted Cable Pull Operator



PUSHBUTTONS



Controls Pushbutton and Pilot Light - CSW30 Series

MAINTAINED FLUSH & EXTENDED PUSH BUTTON CAPS

Fully-assembled operators come standard with one 3/16" (4.8mm) and three 1/16" (1.6mm) gaskets.

Maintained Flush Push Button Cap
(shown with an operator and contact block)

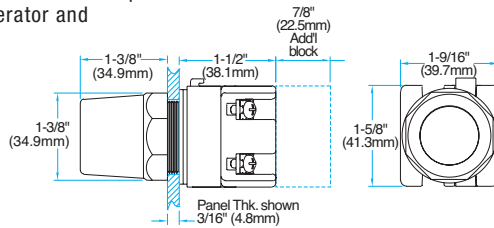

Maintained Extended Push Button Cap

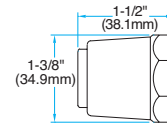

PILOT LIGHTS

Fully-assembled operators come standard with one 3/16" (4.8mm) and two 1/16" (1.6mm) gaskets.

Full Voltage Pilot Light Operator

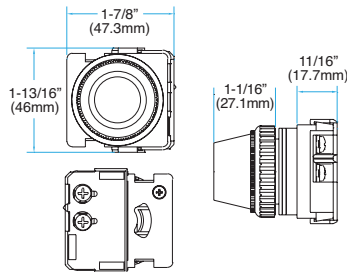

Transformer & Resistor Pilot Light Operators

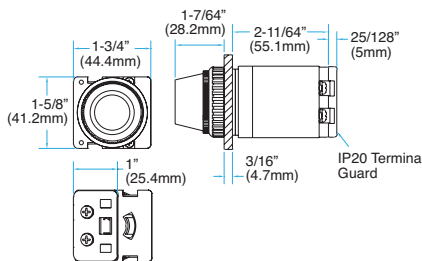

Dual Input Pilot Light Operator

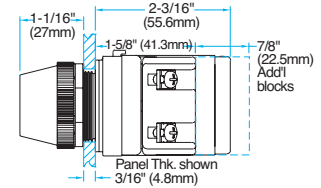

MULTI-VOLTAGE PILOT LIGHT

Fully-assembled operators come standard with four 1/16" (1.6mm) gaskets.

Multi-Voltage Pilot Light

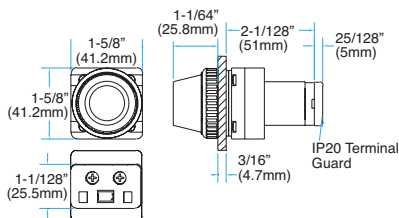

DRILLING

CSW30 Panel Cutout

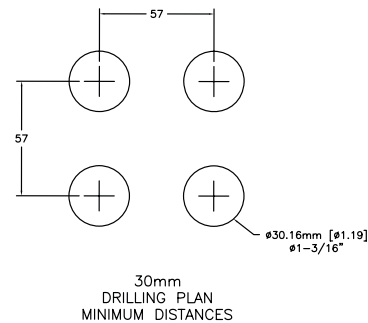

PUSHBUTTONS



Controls

Pushbutton and Pilot Light - CSW30 Series

PUSH-TO-TEST PILOT LIGHTS

Fully-assembled operators come standard with one 3/16" (4.8mm) and three 1/16" (1.6mm) gaskets.

Full Voltage, Transformer & Resistor Push-To-Test Operators

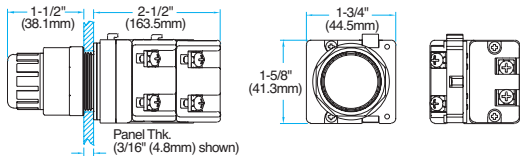

Full Voltage, Transformer & Resistor Push-To-Test Operators

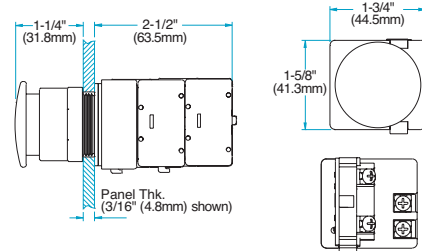

GUARDED LENS

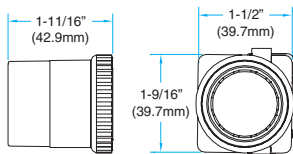

SHROUDED MUSHROOMS LENS

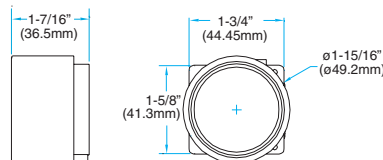

SELECTOR SWITCHES

Fully-assembled operators come standard with one 3/16" (4.8mm) and three 1/16" (1.6mm) gaskets.

Selector Switch Operator (shown with standard handle)

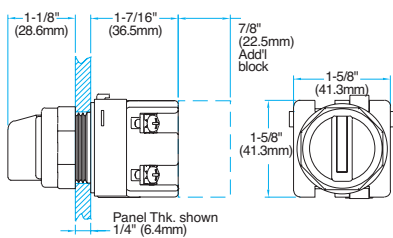

Selector Switch Lever Handle

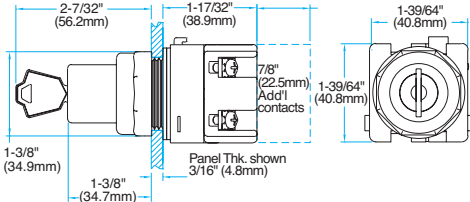
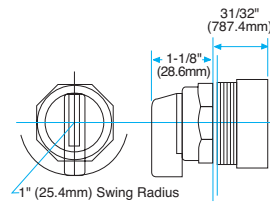

LOCK-OFF ATTACHMENT

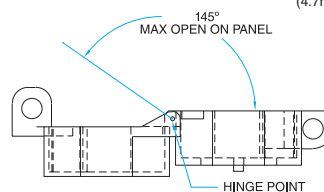
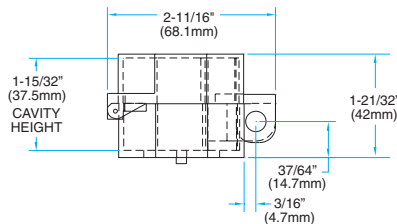
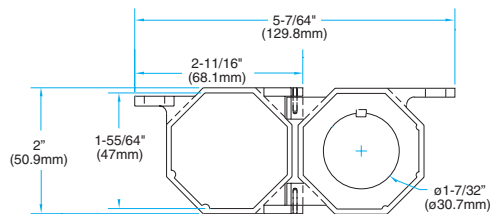

PUSHBUTTONS

Controls

Pushbutton and Pilot Light - CSW30H Series (30mm) Hazardous Duty Pushbuttons

Types

- F - Flush
- S - Extended
- C - Mushroom
- GA - Recessed
- GAI - Illuminated Recessed
- SI - Illuminated Extended
- CI - Illuminated Mushroom

MULTIPLIER SYMBOL FOR CSW30H SERIES - Z55

CSW30H-B

Voltage (see Voltage Code)
Color (see Color Code)

<p>FLUSH</p> <p>CSW30H - _</p> <ul style="list-style-type: none"> ○ BF0 ● BF1 ● BF2 ● BF3 ● BF4 ● BF5 <p>LIST PRICE \$31.00</p>	<p>NON-ILLUMINATED (Extended)</p> <p>CSW30H - _</p> <ul style="list-style-type: none"> ○ BS0 ● BS1 ● BS2 ● BS3 ● BS4 ● BS5 <p>LIST PRICE \$31.00</p>	<p>MUSHROOM (40mm HEAD)</p> <p>CSW30H - _</p> <ul style="list-style-type: none"> ● BC1 ● BC2 ● BC5 <p>LIST PRICE \$42.00</p>	<p>RECESSED</p> <p>CSW30H - _</p> <ul style="list-style-type: none"> ○ BGA0 ● BGA1 ● BGA2 ● BGA3 ● BGA4 ● BGA5 <p>LIST PRICE \$37.00</p>
<p>ILLUMINATED EXTENDED</p> <p>CSW30H - _ *</p> <ul style="list-style-type: none"> ○ BS10 ● BS11 ● BS12 ● BS13 ● BS14 <p>LIST PRICE \$110.00</p>	<p>ILLUMINATED MUSHROOM (40mm HEAD)</p> <p>CSW30H - _ *</p> <ul style="list-style-type: none"> ○ BC10 ● BC11 ● BC12 ● BC13 ● BC14 <p>LIST PRICE \$120.00</p>	<p>ILLUMINATED RECESSED</p> <p>CSW30H - _ *</p> <ul style="list-style-type: none"> ○ BGA0 ● BGA1 ● BGA2 ● BGA3 ● BGA4 <p>LIST PRICE \$115.00</p>	

* Illuminated operators are supplied with LED block. To complete selection, replace "*" with desired voltage: E26 (24Vac/Vdc), D61 (120Vac/Vdc) or D66 (240Vac/Vdc).

Emergency-Stop Pushbuttons

Types

G - Twist release

P - Pull release

CSW30H-B E

CSW30H-S D

Voltage (see Voltage Code)

Color (see Color Code)

<p>E-STOP - TWIST RELEASE</p> <ul style="list-style-type: none"> ● CSW30H-BEG ● CSW30H-BEG2 <p>LIST PRICE \$86.00</p>	<p>E-STOP - PUSH PULL</p> <ul style="list-style-type: none"> ● CSW30H-BEP ● CSW30H-BEP2 <p>LIST PRICE \$80.00</p>	<p>PILOT LIGHTS</p> <p>CSW30H - _ *</p> <ul style="list-style-type: none"> ○ SD0 ● SD1 ● SD2 ● SD3 ● SD4 <p>LIST PRICE \$107.00</p>
--	--	---

CODE CHART

	○	●	●	●	●	●
--	---	---	---	---	---	---

LED Block Voltage	
E26	24Vac/Vdc
D61	120Vac/Vdc
D66	240Vac/Vdc



PUSHBUTTONS

Controls

Pushbutton and Pilot Light - CSW30H Series (30mm) Hazardous Duty

Selector Switches

Types

K - Knob

A - Lever

CSW30H-C

No. of Positions

2 - Two positions

3 - Three positions

Angle

45 - 45°

90 - 90°

Handle

F - Maintained

R - Spring return

RE - Spring return from left

RD - Spring return from right



NOB	LEVER	POSITION	DIAGRAM
 <p>LIST PRICE Maintained \$44.00 Spring Return \$62.00</p>	 <p>LIST PRICE Maintained \$44.00 Spring Return \$62.00</p>		
CSW30H-CK2F90	CSW30H-CA2F90	I ∨ II	1
CSW30H-CK2R90	CSW30H-CA2R90	I ∨ II	1
CSW30H-CK3F45	CSW30H-CA3F45	I 0 II	2 & 3
CSW30H-CK3R45	CSW30H-CA3R45	I 0 II	2 & 3
CSW30H-CK3RE45	CSW30H-CA3RE45	I 0 II	2 & 3
CSW30H-CK3RD45	CSW30H-CA3RD45	I 0 II	2 & 3

DIAGRAM 1 - Hermetically & Factory Sealed Block

HANDLE POSITION		Auxiliary Contact	Mounting Position
I	II		
0	X	NO	Either
X	0	NC	Either
0	X	NO & NC	Either
X	0		

X = CLOSED

0 = OPEN

DIAGRAM 2 - Factory Sealed Block

HANDLE POSITION			Auxiliary Contact	Mounting Position
I	0	II		
X	0	0	NO & NC	Left
0	X	0		
0	0	X	NO & NC	Right
0	X	0		

DIAGRAM 3 - Hermetically Sealed Block

HANDLE POSITION			Auxiliary Contact	Mounting Position
I	0	II		
X	0	0	NO	Left
0	0	X	NO	Right
0	X	X	NC	Left
X	X	0	NC	Right
X	0	X	2NO	wired in parallel
0	X	0	2NC	wired in series
X	0	X	early make	Either
0	X	X	late break	Left
X	X	0	late break	Right

PUSHBUTTONS



Factory Sealed / Hermetically Sealed Contact Blocks

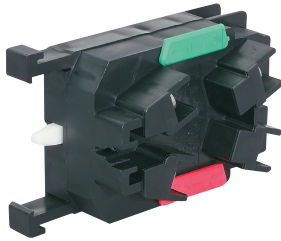
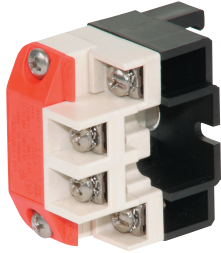

Auxiliary Contact Blocks - Factory Sealed (720VA) Product Description	Catalog Number	List Price	Multiplier Symbol
Linear devices - 1NO & 1NC	BC11FS-CSW30H	\$120.00	Z55
For rotary devices only - 1NO & 1NC	BC11FSR-CSW30H		
Auxiliary Contact Blocks - Hermetically Sealed (360VA inductive)			
Product Description			
Power reed - 1NO	BC10PR-CSW30H	\$95.00	Z55
Power reed - 1NC	BC01PR-CSW30H		
Power reed - 2NO	BC20PR-CSW30H	\$150.00	
Power reed - 2NC	BC02PR-CSW30H		
Power reed - 1NO & 1NC	BC11PR-CSW30H		
Auxiliary Contact Blocks - Hermetically Sealed (180VA inductive)			
Product Description			
Mid-power reed - 1NO	BC10MP-CSW30H	\$75.00	Z55
Mid-power reed - 1NC	BC01MP-CSW30H		
Mid-power reed - 2NO	BC20MP-CSW30H	\$130.00	
Mid-power reed - 2NC	BC02MP-CSW30H		
Mid-power reed - 1NO & 1NC	BC11MP-CSW30H		
Auxiliary Contact Blocks - Hermetically Sealed (40VA inductive / 100W resistive)			
Product Description			
Mid-logic reed - 1NO	BC10ML-CSW30H	\$45.00	Z55
Mid-logic reed - 1NC	BC01ML-CSW30H		
Mid-logic reed - 2NO	BC20ML-CSW30H	\$70.00	
Mid-logic reed - 2NC	BC02ML-CSW30H		
Mid-logic reed - 1NO & 1NC	BC11ML-CSW30H		
Auxiliary Contact Blocks - Hermetically Sealed (40W resistive)			
Product Description			
Logic reed - 1NO	BC10LR-CSW30H	\$28.00	Z55
Logic reed - 1NC	BC01LR-CSW30H		

Legend Plates

Please see selection in 30mm Industrial section of catalog page B-236.

CLAMP RING WRENCH

CPAW30

Simplifies the tightening or loosening of polyester and aluminum 1-3/8" clamp rings.

LIST PRICE \$30.00

30MM HOLE PLUG

ATR30

NEMA 4X rated plug to seal up unwanted panel holes.

LIST PRICE \$25.00

PUSHBUTTONS



Controls

Pushbutton and Pilot Light - CSW30H Series (30mm) Hazardous Duty

Technical Data

FACTORY SEALED: Contact Blocks are Certified as "Explosion Proof". Devices employing this method of protection are designed so that all electrical parts are enclosed in a switch housing that is capable of withstanding, without damage, an explosion of a specified gas or vapor/air mixture which may occur during the operation of the switch. Further, the explosion internal to the switch body is controlled so that the hot gases are extinguished and cooled before they are allowed to escape to the surrounding atmosphere.

HERMETICALLY SEALED: Contact Blocks are Certified as "Non-Incendive". Devices employing this method of protection are designed so that all electrical parts are a bonded part of the switch housing that forms an arcing chamber that is evacuated of all oxygen, filled with an inert gas, and then sealed to prohibit the exchange of gases with the surrounding environment. These devices are incapable of igniting the surrounding gases or vapor/air mixtures under normal operation. Devices of this type are suitable for use in Div. 2/ Zone 2 applications. Hermetically Sealed contact blocks are also extremely useful for switching low energy circuits or circuits applied in atmospheres containing oxidizing agents and pollutants that might effect the performance of silver switching and metal contact elements. Hermetically Sealed Switch performance is consistent and repeatable in almost any environment.

DIELECTRIC STRENGTH (MECHANICAL CONTACTS) 2200V for 1 Minute

FACTORY SEALED CONTACT BLOCK					
Class I Div. 2 Gr. B,C, & D / Zone 2 Gr. IIB +H2					
Utilization Category					
	IEC	UL	Make Rating	Break Rating	Ith-Thermal Current
AC	AC-15	A600	7200VA	720VA	10A
DC	DC-13	Q300	69VA	69VA	2.5A

NOTE: For AC voltage below 72V AC the max. allowed switching current is 10A = Ith.
For DC voltages below 28V DC the max. allowed switching current is 2.5A = Ith.
For switching applications below 24V/40mA, Hermetic REED contacts are recommended.

HERMETICALLY SEALED MID-POWER REED CONTACT BLOCK					
Class I Div. 2 Gr. A, B, C, & D/Zone 2 Gr. IIC					
Utilization Category					
	IEC	UL	Make Rating	Break Rating	Ith-Thermal Current
AC	AC-15	C300	1800VA	180VA	2.5A
DC	DC-13	Q150	69VA	69VA	2.5A

NOTE: For AC voltage below 72VAC the max. allowed switching current is 2.5A = Ith.
For DC voltages below 28VDC the max. allowed switching current is 2.5A = Ith.
Suitable for switching DRY Circuits and Low Energy Circuits (Less than 24V-40mA).

HERMETICALLY SEALED POWER REED CONTACT BLOCK					
Class I Div. 2 Gr. A, B, C, & D/Zone 2 Gr. IIC					
Utilization Category					
	IEC	UL	Make Rating	Break Rating	Ith-Thermal Current
AC	AC-15	B300	3600VA	360VA	5A
	AC-15	C600	1800VA	180V	2.5A
DC	DC-13	Q300	69VA	69VA	2.5A

NOTE: For AC voltage below 72V AC the max. allowed switching current is 5A = Ith.
For DC voltages below 28V DC the max. allowed switching current is 2.5A = Ith.
Suitable for switching DRY Circuits and Low Energy Circuits (Less than 24V-40mA).

HERMETICALLY SEALED LOGIC REED CONTACT BLOCK					
Class I Div. 2 Gr. A, B, C, & D/Zone 2 Gr. IIC					
Utilization Category					
	IEC	UL	Inductive	Resistive	Ith-Thermal Current
AC		220V Max.	N/A	40 Watt	2A

Suitable for switching DRY Circuits and Low Energy Circuits (Less than 24V-40mA).

HERMETICALLY SEALED MID-LOGIC REED CONTACT BLOCK					
Class I Div. 2 Gr. A, B, C, & D/Zone 2 Gr. IIC					
Utilization Category					
	IEC	UL	Inductive	Resistive	Ith-Thermal Current
AC	AC-12	250V Max.	40VA	100 Watt	3A

Suitable for switching DRY Circuits and Low Energy Circuits (Less than 24V-40mA).

INDICATING LIGHTS	
Light Unit	T-Code
FV Incandescent Lights	T4A
FV LED Lights	T6 [No marking required]
Resistor Lights	T3C
Light Unit	T-Code
Resistor LED Lights	T6
Transformer Lights Incd. & LED	T4A
Multi-Voltage 20V-240V LED Light	T4A

MATERIALS

- Thermoplastic Polyester and Polyester Blends (UV Stabilized for outdoor use)
 - Operator Housings
 - Operator Caps and Handles – Non-Illuminated (Glass Reinforced Grades)
 - Mounting Rings and Nuts
 - Thrust Washer
 - Trim Washer
- High Impact Polycarbonate (UV Stabilized for outdoor use)
 - Pilot Light Lens
 - Transparent PB and Mushroom Caps
- Custom Polymers
 - Certain CAM and Bearing parts are Teflon, Silicone, & Moly-Disulfide Impregnated for improved wearability
 - Fluorosilicone and Thermoplastic Neoprene Boot Accessories

- Seals
 - Neoprene Gaskets
 - Thermoplastic – Molded Neoprene and alloy derivatives
 - BUNA N – Rubber – Teflon Coated
 - Thermoplastic – Elastomer Molded Seals
 - Fluorosilicone – Boots
- Metal: Stainless Steel
 - Push Pull Bushings
 - Internal tubes for Maintained Devices
 - Detents for Maintained Devices
 - Stainless Steel Springs and Screws throughout
- Aluminum
 - Optional Mounting Nut

ENVIRONMENTAL RATINGS

Type 1, 2, 3, 3R, 4/4X, 12, 13, and IP65
Operating Temperature -40 to +131° F (-40 to +55° C)
Storage Temperature -40 to +185° F (-40 to +85° C)
Operating environments below freezing temperatures are assumed to be absent of freezing liquids or pollutants.

TERMINAL & WIRING CONSIDERATION

Wire- AWG 22-12 CU (Copper Only – Solid & Stranded) [.5 ~ 4 mm ²] One or Two wires permitted per termination
Recommended Tightening Torque 7 lb-in (+3.0/-0.0 lb-in) — [.8 Nm]

PUSHBUTTONS



Controls

Pushbutton and Pilot Light - CSW30H Series (30mm) Hazardous Duty

MOMENTARY NON-ILLUMINATED H-LINE PUSH BUTTONS

Fully-assembled operators come standard with one 3/16" (4.8mm) and three 1/16" (1.6mm) gaskets.

Non-Illuminated Operator
(shown with Flush Cap & Factory Sealed Contact Block)

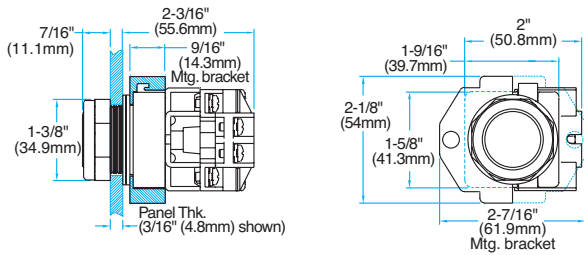

Momentary Extended Cap

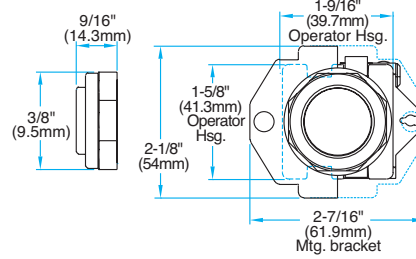

MOMENTARY 1-1/2" (38MM) MUSHROOM CAP

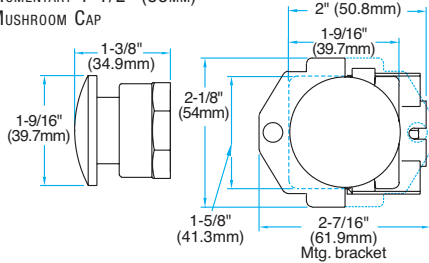

MOMENTARY GUARDED FLUSH CAP

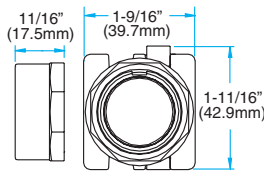

MOMENTARY GUARDED EXTENDED CAP

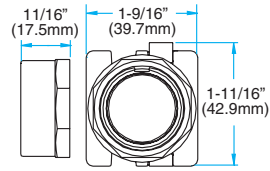

MOMENTARY 2-1/4" (57.2MM) JUMBO MUSHROOM CAP

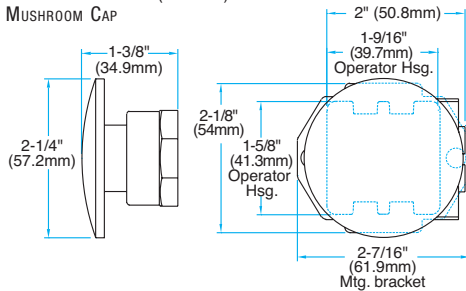

Momentary 1-1/2" (38mm) Shrouded Mushroom Cap

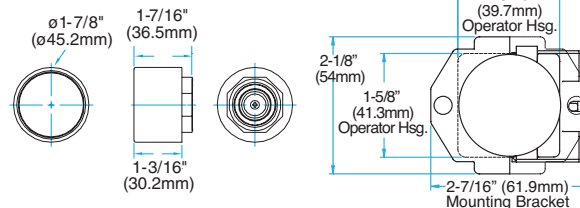

Momentary Fluorosilicone Rubber Boot

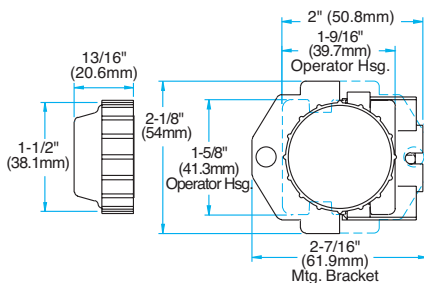

NON-ILLUMINATED PUSH BUTTON MOUNTING BRACKET

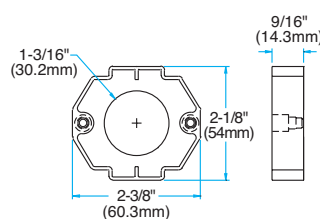

MOMENTARY 2-1/4" (57.2MM) SHROUDED JUMBO MUSHROOM CAP

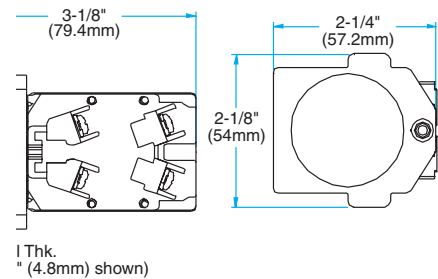

PUSHBUTTONS



Controls

Pushbutton and Pilot Light - CSW30H Series (30mm) Hazardous Duty

MAINTAINED NON-ILLUMINATED H-LINE PUSH BUTTONS

Fully-assembled operators come standard with one 3/16" (4.8mm) and three 1/16" (1.6mm) gaskets.

2-POSITION PUSH-PULL MAINTAINED
1-1/2" (38MM) MUSHROOM CAP

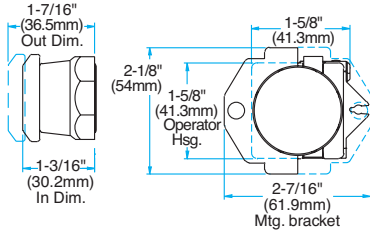

2-Position Push-Pull Maintained Operator
(shown with 2-1/4" (57.2mm) Jumbo Mushroom Cap)

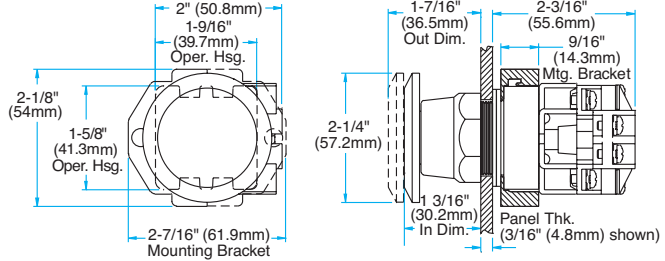

MOMENTARY ILLUMINATED H-LINE PUSH BUTTONS

Fully-assembled operators come standard with one 3/16" (4.8mm) and three 1/16" (1.6mm) gaskets.

Illuminated Full Voltage Operator

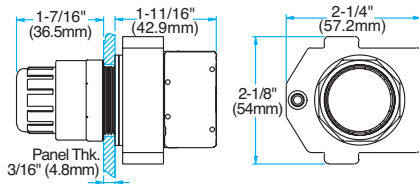

Illuminated Transformer, Resistor
and Dual Input Operators

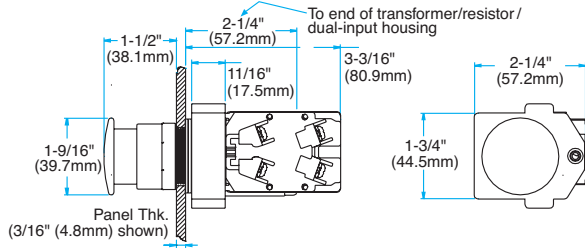

ILLUMINATED PUSH BUTTON MOUNTING
BRACKET

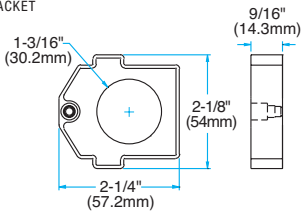

ILLUMINATED SHROUDED
MUSHROOM LENS

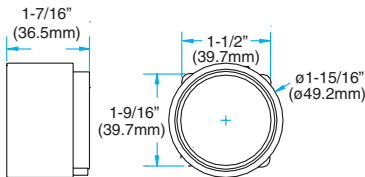

ILLUMINATED GUARDED LENS

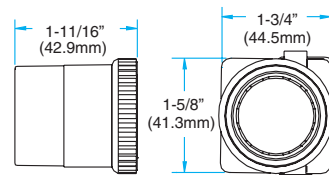

2-POSITION PUSH-PULL MAINTAINED ILLUMINATED H-LINE PUSH BUTTONS

Fully-assembled operators come standard with one 3/16" (4.8mm) and three 1/16" (1.6mm) gaskets.

Illuminated Full Voltage Operator

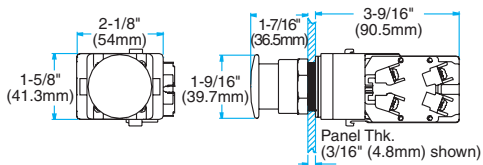

Illuminated Transformer and Resistor Operators

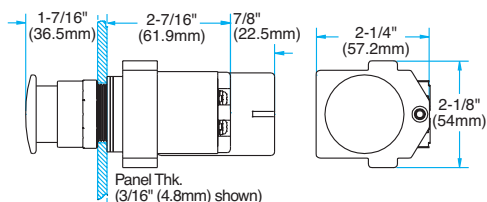

PUSHBUTTONS



Controls

Pushbutton and Pilot Light - CSW30H Series (30mm) Hazardous Duty

H-LINE PILOT LIGHTS

Fully-assembled operators come standard with one 3/16" (4.8mm) and two 1/16" (1.6mm) gaskets.

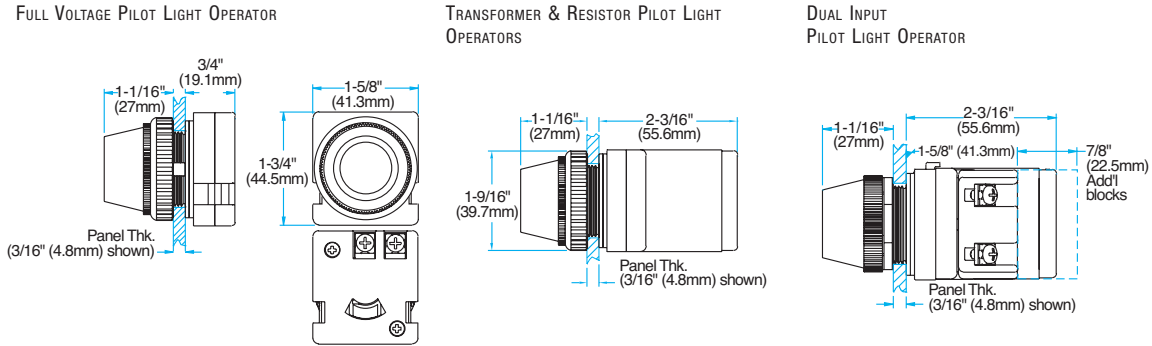

PUSH-TO-TEST H-LINE PILOT LIGHTS

Fully-assembled operators come standard with one 3/16" (4.8mm) and three 1/16" (1.6mm) gaskets.

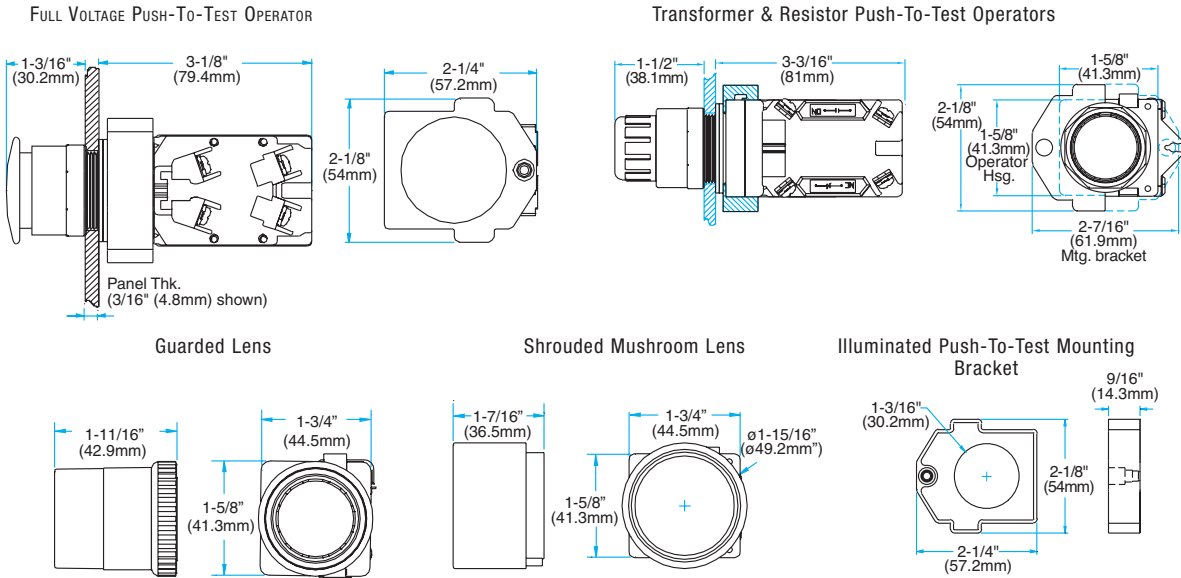

MULTI-VOLTAGE H-LINE PILOT LIGHT

Fully-assembled operators come standard with four 1/16" (1.6mm) gaskets.

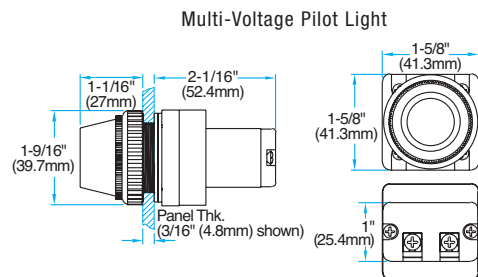

PUSHBUTTONS



Controls

Pushbutton and Pilot Light - CSW30H Series (30mm) Hazardous Duty

H-LINE SELECTOR SWITCHES

Fully-assembled operators come standard with one 3/16" (4.8mm) and three 1/16" (1.6mm) gaskets.

Selector Switch Operator
(shown with standard handle)

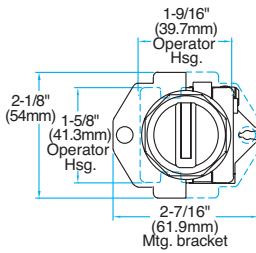
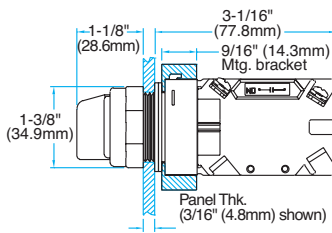

Selector Switch Lever Handle

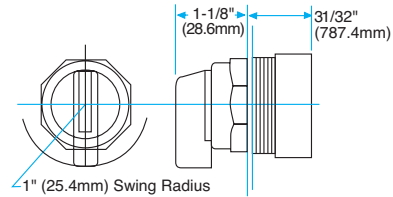

Selector Switch Mounting Bracket

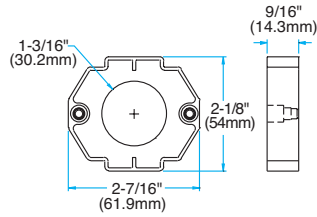

H-LINE CONTACT BLOCKS

Factory Sealed Contact Block

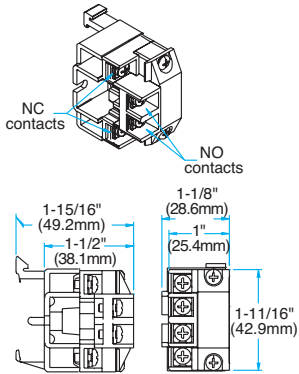

Power Reed, Mid-Power Reed & Medium Logic Reed Contact Blocks

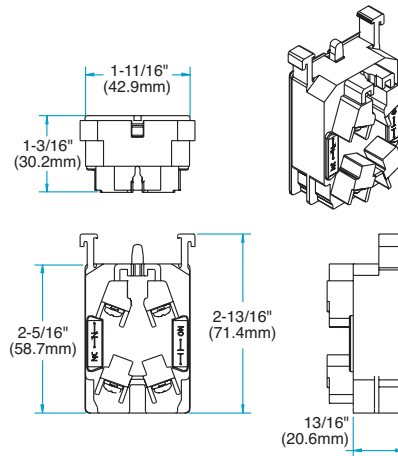

LOGIC REED CONTACT BLOCK

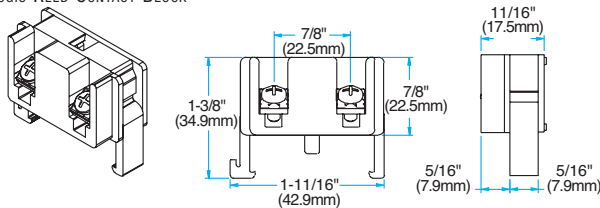

PUSHBUTTONS



Controls

Pushbutton and Pilot Light - CSW30H Series (30mm) Hazardous Duty

MAINTAINED FLUSH & EXTENDED H-LINE PUSH BUTTON CAPS

Fully-assembled operators come standard with one 3/16" (4.8mm) and three 1/16" (1.6mm) gaskets.

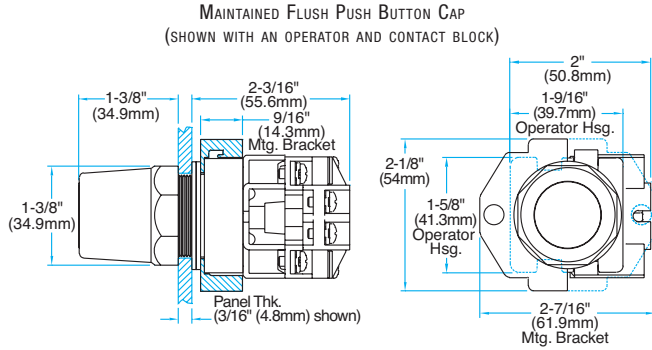

MAINTAINED EXTENDED PUSH BUTTON CAP

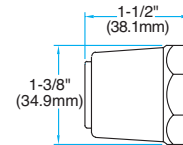

H-LINE RESET PUSH BUTTON

Fully-assembled operators come standard with one 3/16" (4.8mm) and three 1/16" (1.6mm) gaskets.

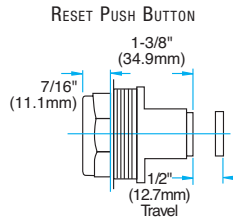

GUARD ATTACHMENT

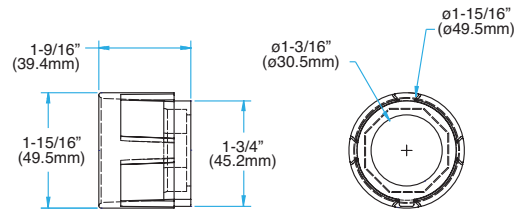

LOCK-OFF ATTACHMENT

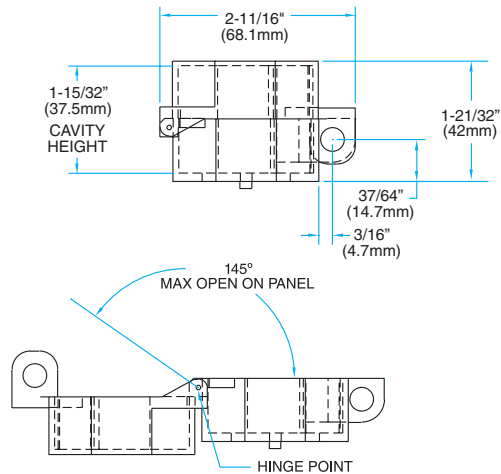
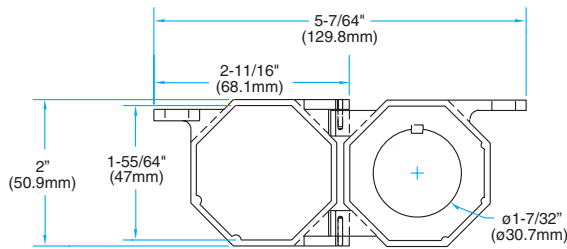

PUSHBUTTONS





Controls Pushbuttons Stations and Enclosures - CSW Series

Fiberglass reinforced polyester construction

Available in 22mm and 30mm versions.

Tongue and Groove type neoprene gasket

Protects from dirt , dust , oil and water (NEMA 4 , 4X and 12)

Comes complete with contact blocks and legend plates on Pre-Assembled Stations.

Empty Enclosure available for 22mm and 30mm Pilots Devices.

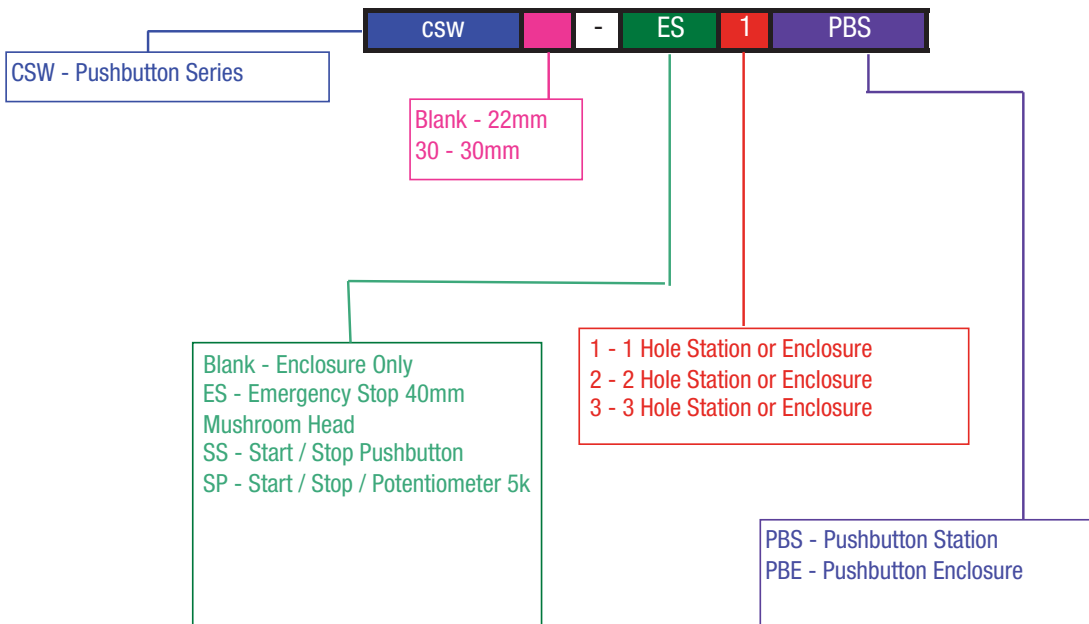

PUSHBUTTONS



Controls

Pushbuttons Stations and Enclosures - CSW Series

Pushbutton Station



Part Number	Description	List	Multiplier Symbol	Size (Inches)
CSW-ES1PBS	E-Stop Mushroom -1 N.C.Contact Block and Legend	\$150.00	Z5	7x4x3
CSW-SS1PBS	Start/Stop Combo Button - 1-N.C. and 1-N.O. Contact Blocks	\$150.00	Z5	7x4x3
CSW-SS2PBS	Start/Stop Pushbuttons - 1-N.C. and 1-N.O. Contact Blocks and Legend	\$175.00	Z5	7x4x3
CSW-SP3PBS	Start/Stop Pushbuttons - 1-N.C and 1- N.O. Contact Block , Potentiometer 5k and Legends	\$460	Z5	9x4x3
CSW30-ES1PBS	Same as CSW-ES1PBS - 30mm	\$260	Z55	7x4x3
CSW30-SS2PBS	Same as CSW-SS2PBS - 30mm	\$240	Z55	7x4x3
CSW30-SP3PBS	Same as CSW-SP3PBS - 30mm	\$535	Z55	9x4x3

Custom stations available upon request.

Part Number	Descript	List	Multiplier Symbol	Size (Inches)
CSW-1PBE	22mm 1 Hole Enclosure	\$120.00	Z5	7x4x3
CSW-2PBE	22mm 2 Hole Enclosure	\$120.00	Z5	7x4x3
CSW-3PBE	22mm 3 Hole Enclosure	\$125.00	Z5	9x4x3
CSW30-1PBE	30mm 1 Hole Enclosure	\$120.00	Z55	7x4x3
CSW30-2PBE	30mm 2 Hole Enclosure	\$120.00	Z55	7x4x3
CSW30-3PBE	30mm 3 Hole Enclosure	\$125.00	Z55	9x4x3

